

# PRODUCT CATEGORY

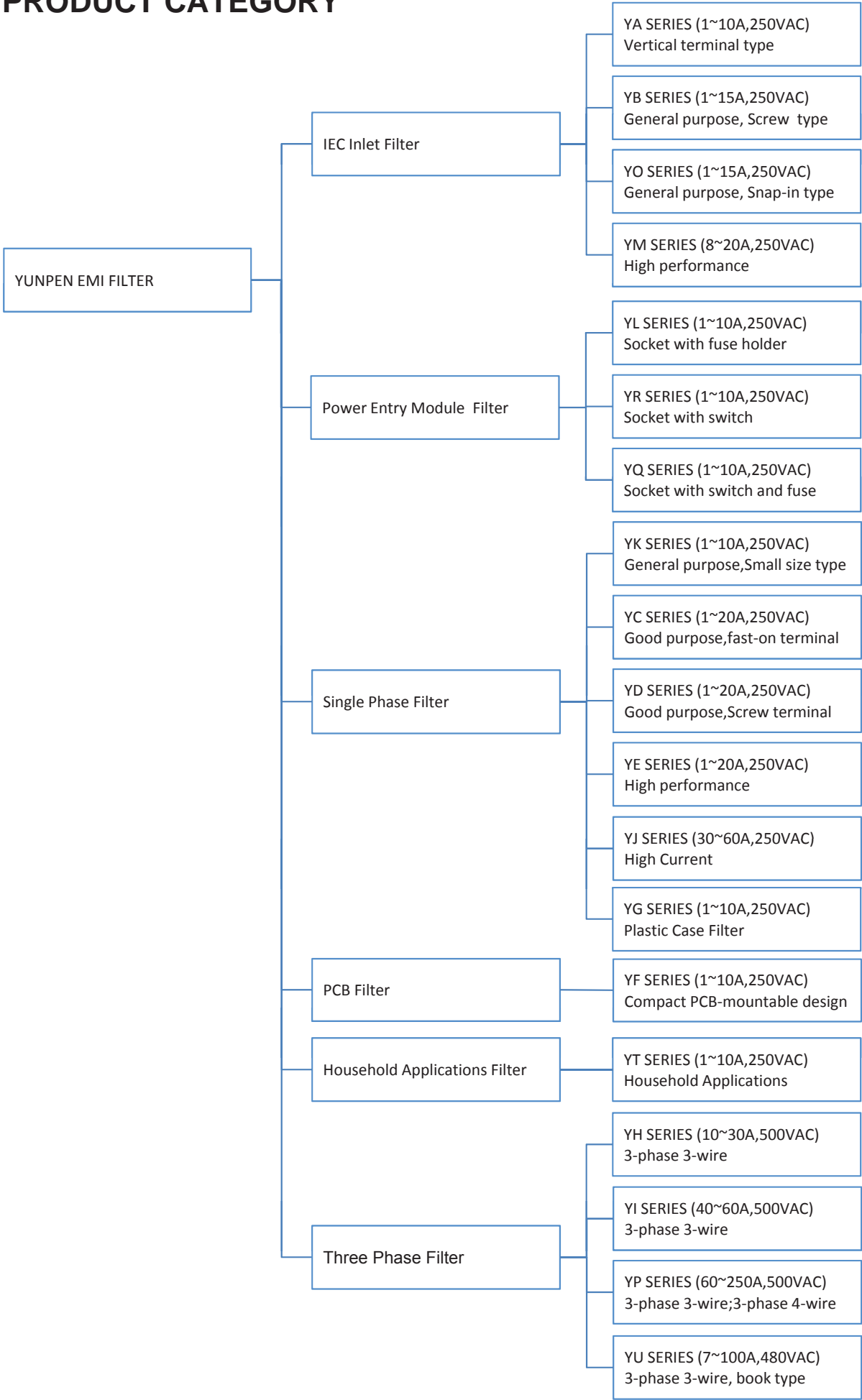

\* Medical version (with bleed resistor and without Y2-capacitor)

---

# Products Index

1. YA .....	1
2. YB .....	3
3. YC, YD .....	5
4. YC, YD-L2 .....	7
5. YE .....	9
6. YE-L2 .....	11
7. YF-T6, T8 .....	13
8. YF-T12 .....	15
9. YG-T5, T13 .....	17
10. YH .....	19
11. YI .....	21
12. YJ .....	23
13. YK .....	25
14. YL .....	27
15. YM ,YMB.....	29
16. YMA .....	31
17. YO .....	33
18. YP .....	35
19. YQ .....	37
20. YR .....	39
21. YT .....	41
22. YU-TB .....	43
23. YU-HD .....	45
24. Technical Summary .....	47

OEM SERIES

PRDUCD CATGORY

# YA SERIES (IEC Inlet Filters)



## Features

- The YA series filter integrates an IEC inlet and filter with excellent noise suppression performance and compact size.
- The rated current can be offered up to 10 amps.
- Various output selections such as fast-on terminal, solder lug terminal, PCB terminal, and lead wire.
- Low leakage current version upon requested.
- Custom-specific versions are available on request.
- Application for Electrical and electronic equipment, Single-phase power supplies, UPS, Medical equipment, Test and measurement equipment.

## Technical Specification

Rated voltage	125/250VAC
Rated currents	1 to 10A
Operating frequency	50/60Hz
Hipot rating(Line-to-line)	1450VDC
Hipot rating(Line-to-ground)	2250VDC
Operating temperature	-25~+85°C
Safety compliance	UL, CSA, VDE, CQC, CE

## Typical electrical schematic

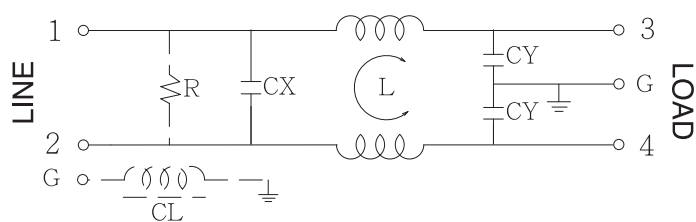

\*With optional ground choke and resistor.

R: 1M ohm

CL: 100  $\mu$  H

## Filter Selection Table

Part No.	Rated Current A	Inductance L(mH)	Capacitance CX( $\mu$ F)	Capacitance CY(pF)	Output connections
YA01T1	1	3.7	0.1	3300	Fast-on terminal (optional lead-wire)
YA03T1	3	1.8	0.1	3300	
YA06T1	6	0.7	0.1	3300	
YA10T1	10	0.3	0.1	3300	
YA01T3	1	3.7	0.1	3300	Solder lug terminal
YA03T3	3	1.8	0.1	3300	
YA06T3	6	0.7	0.1	3300	
YA10T3	10	0.3	0.1	3300	
YA01P	1	3.7	0.1	3300	PCB terminal
YA03P	3	1.8	0.1	3300	
YA06P	6	0.7	0.1	3300	
YA10P	10	0.3	0.1	3300	

\*Please contact us for other parts or spec.

## YA-T1

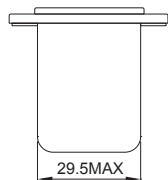
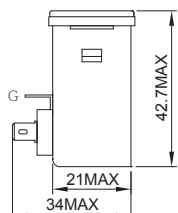
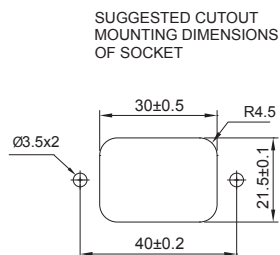

## YA-T3

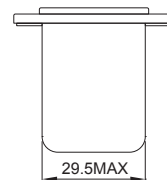
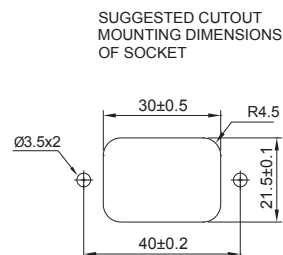
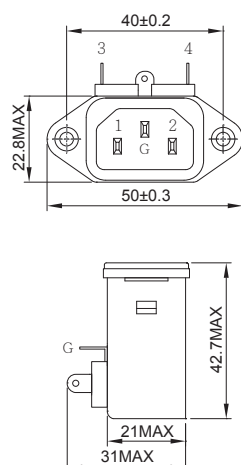

## YA-P

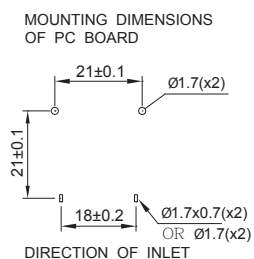
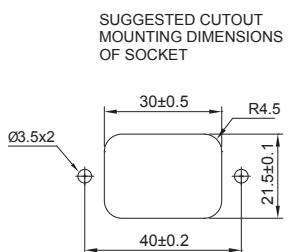
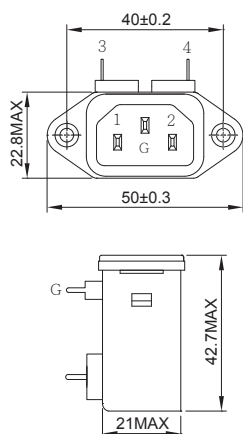

## YA-T (Lead-wire)

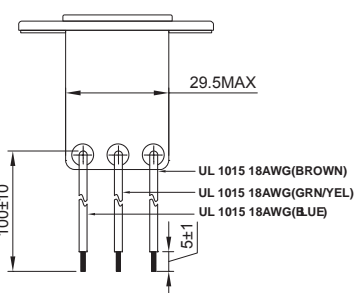
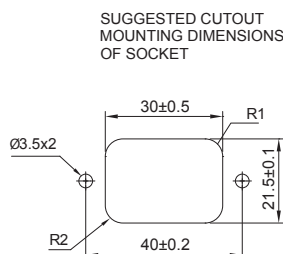
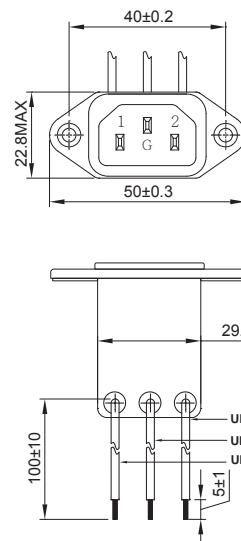

## YA-01A

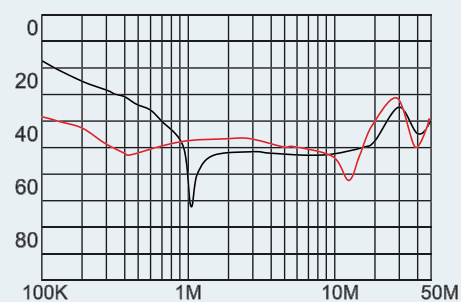

## YA-03A

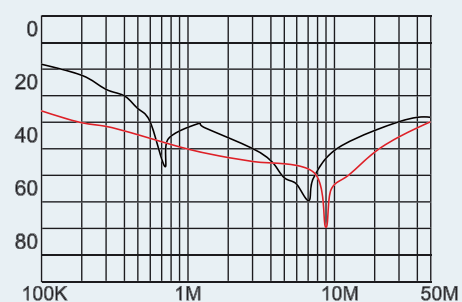

## YA-06A

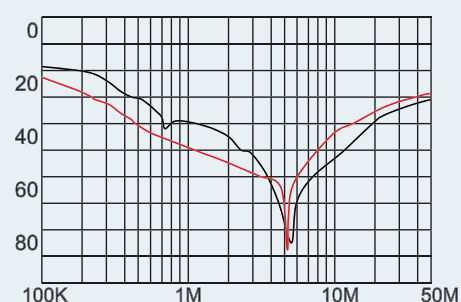

## YA-10A

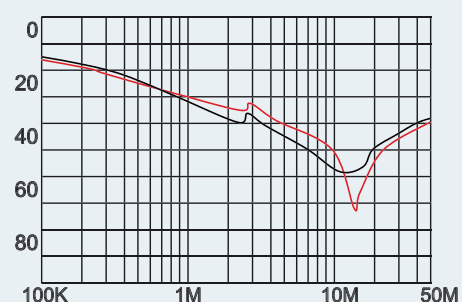

# YB SERIES (IEC Inlet Filters)



## Features

- The YB series filter integrates an IEC inlet and filter with excellent noise suppression performance and compact size.
- The rated current can be offered up to 15 amps.
- Various output selections such as fast-on terminal, solder lug terminal, and lead wire.
- The choice of integrated earth line choke is also available.
- Low leakage current version upon requested.
- Approved by UL, CSA, VDE, CQC and CE
- Custom-specific versions are available on request
- Application for Electrical and electronic equipment, Single-phase power supplies, UPS, Medical equipment, Test and measurement equipment.

## Technical Specification

Rated voltage	125/250VAC
Rated currents	1 to 15A
Operating frequency	50/60Hz
Hipot rating(Line-to-line)	1450VDC
Hipot rating(Line-to-ground)	2250VDC
Temperature rise	40°C MAX
Operating temperature	-25~+85°C
Safety compliance	1 to 10A (VDE,CQC) ; 1 to 15A (UL,CSA)

\*CSA except YB08T and YB15T

## Typical electrical schematic

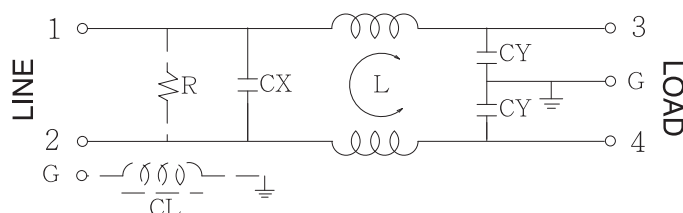

\*With optional ground choke and resister.

R: 1M ohm

CL: 100  $\mu$  H

## Filter Selection Table

Part No.	Rated Current A	Inductance L(mH)	Capacitance CX( $\mu$ F)	Capacitance CY(pF)	Output connections
YB01A1/T1	1	3.7	0.1	3300	Fast-on terminal (optional lead-wire)
YB03A1/T1	3	1.8	0.1	3300	
YB06A1/T1	6	0.7	0.1	3300	
YB08A1/T1	8	1.8	0.1	3300	
YB10A1/T1	10	0.3	0.1	3300	
YB15A1/T1	15	0.3	0.1	3300	
YB01A3/T3	1	3.7	0.1	3300	Solder lug terminal
YB03A3/T3	3	1.8	0.1	3300	
YB06A3/T3	6	0.7	0.1	3300	
YB08A3/T3	8	1.8	0.1	3300	
YB10A3/T3	10	0.3	0.1	3300	
YB15A3/T3	15	0.3	0.1	3300	

\*Please contact us for other parts or spec.

## Physical Dimensions: (mm)

YB-A1

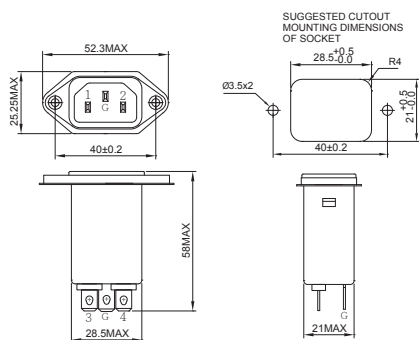

YB-A1-A

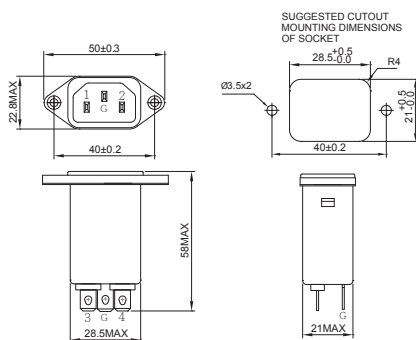

YB-A3

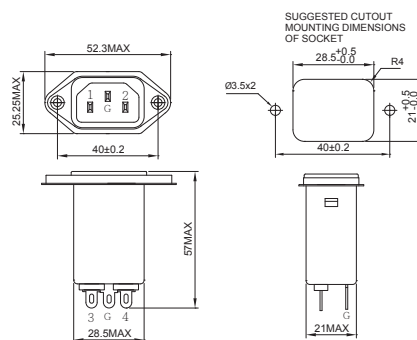

YB-A3-A

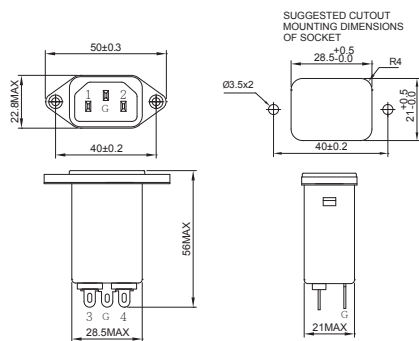

YB-T1

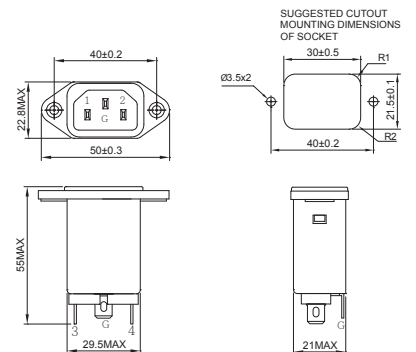

YB-T3

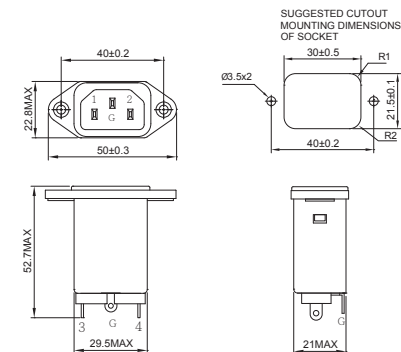

YB-A (lead-wire)

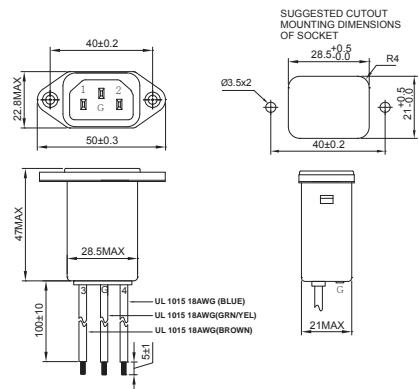

## Typical filter attenuation (Common mode — Normal mode —)

YB-01

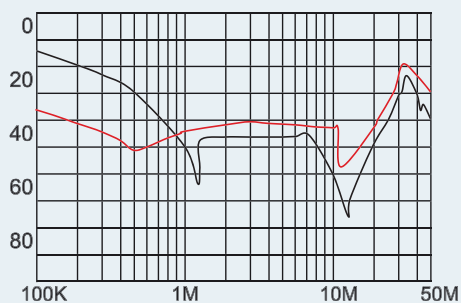

YB-03

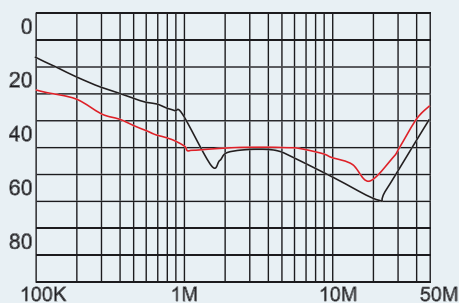

YB-06

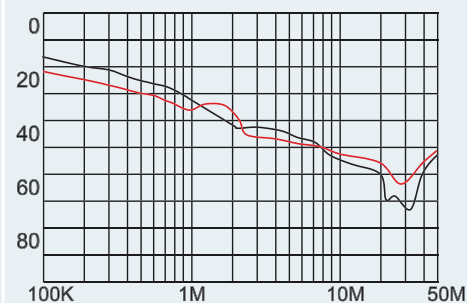

YB-08

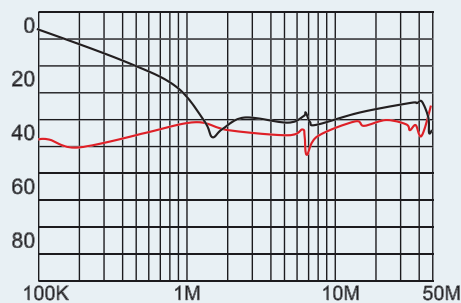

YB-10

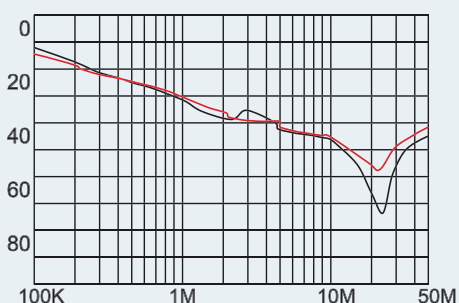

YB-15

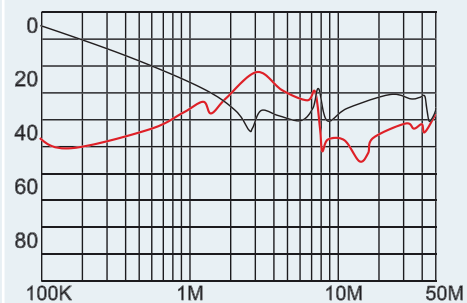

# YC, YD SERIES (Single Phase One-Stage Filters)



## Features

- The YC and YD series are general purpose single phase one-stage filter.
- The rated current can be offered up to 20 amps.
- Various output selections such as fast-on terminal, M4 screw terminals and lead wire.
- Low leakage current version upon requested.
- Approved by UL, CSA, VDE and CE
- Custom-specific versions are available on request
- Application for Electrical and electronic equipment, Household equipment, Automation equipment, Fitness machine, Medical equipment

## Technical Specification

Rated voltage	125/250VAC
Rated currents	Up to 20A
Operating frequency	50/60Hz
Hipot rating(Line-to-line)	1450VDC
Hipot rating(Line-to-ground)	2250VDC
Operating temperature	-25~+85°C
Safety compliance	YC series (UL,CSA,CE) ; YD series (UL,CSA,VDE,CE)

## Typical electrical schematic

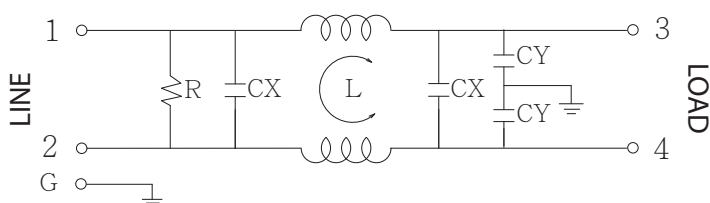

## Filter Selection Table

Part No.	Rated Current (A)	Inductance L(mH)	Capacitance CX(μF)	Capacitance CY(pF)	Resistance R(ohm)	Output connections
YC05T1	5	1.7	0.1	3300	10M	Fast-on terminal
YC10T1	10	1.2	0.1	3300	10M	
YC15T1	15	0.9	0.1	3300	10M	
YC20T1	20	0.5	0.1	3300	10M	
YD05T4	5	1.7	0.1	3300	10M	M4 Screw terminals
YD10T4	10	1.2	0.1	3300	10M	
YD15T4	15	0.9	0.1	3300	10M	
YD20T4	20	0.5	0.1	3300	10M	

## Physical Dimensions: (mm)

YC-T1

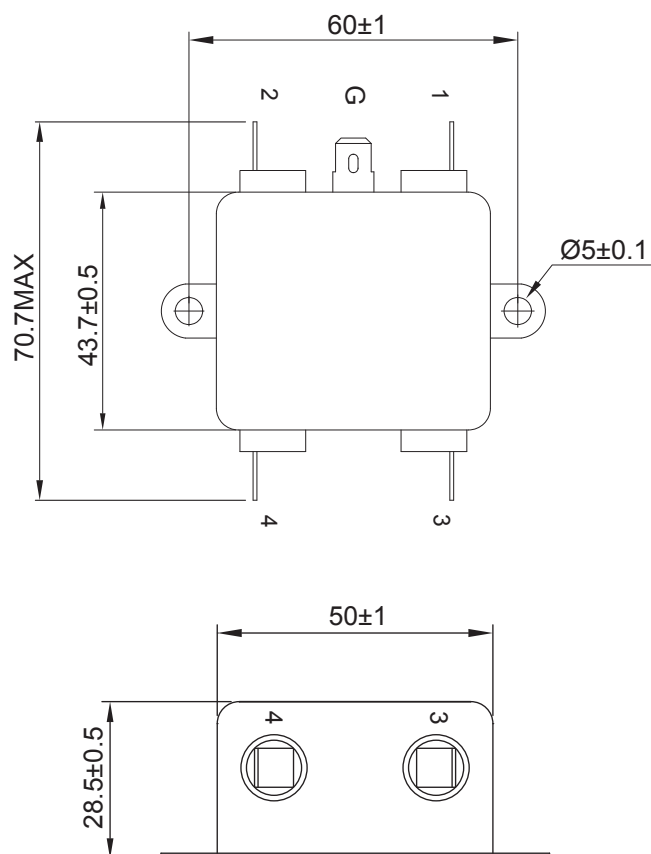

YD-T4

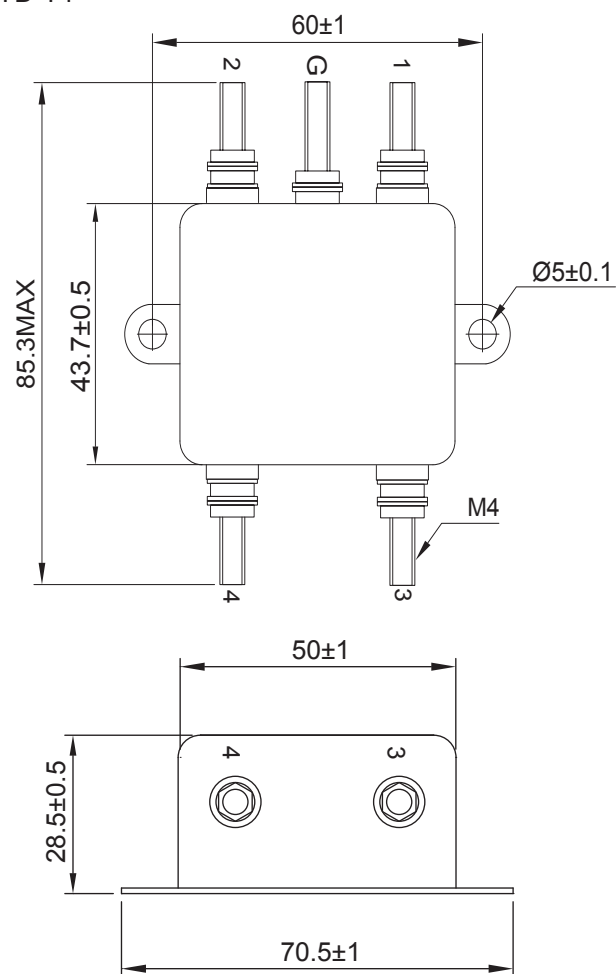

## Typical filter attenuation (Common mode — Normal mode —)

YC, YD-05

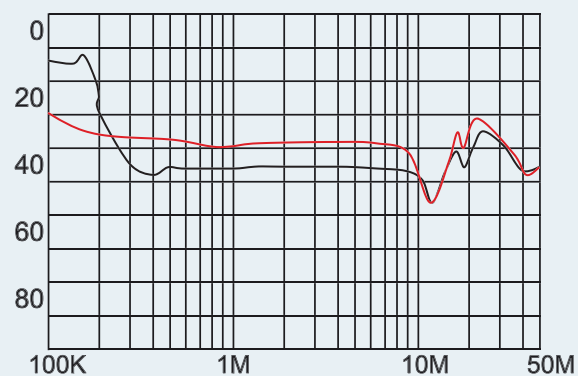

YC, YD-10

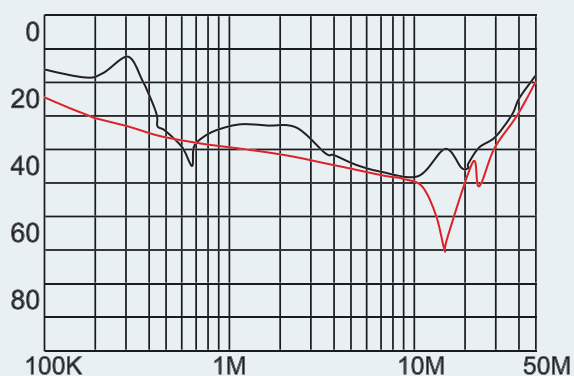

YC, YD-15

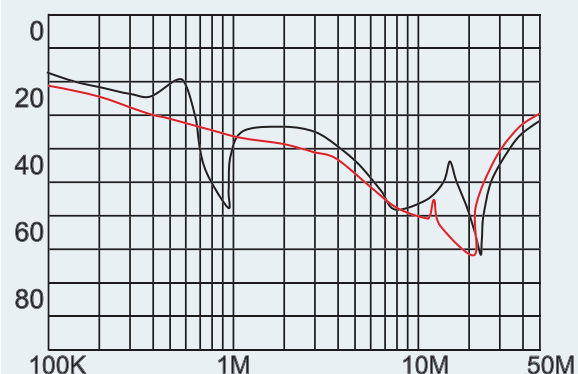

YC, YD-20

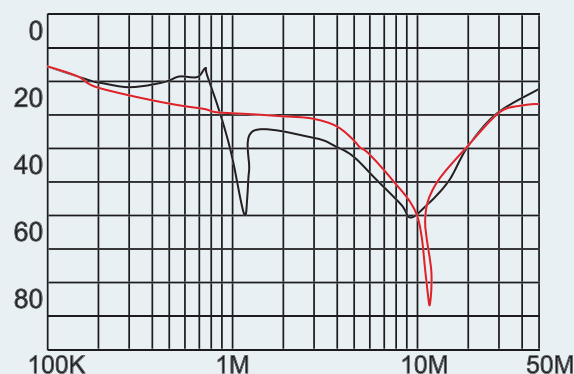



# YC, YD-L2 SERIES (Single Phase Two-Stage Filters)



## Features

- Two stage filters designed to provide high performance in suppressing both line-to-line and line-to-ground noise for most digital electronic equipment.
- The rated current can be offered up to 10 amps.
- Various output selections such as fast-on terminal, M4 screw terminals
- Low leakage current version upon requested.
- Approved by UL, CSA, VDE and CE
- Custom-specific versions are available on request
- Application for Electrical and electronic equipment, Household equipment, Automation equipment, Fitness machine, Various noisy applications requiring high filter performance

## Technical Specification

Rated voltage	125/250VAC
Rated currents	1 to 10A
Operating frequency	50/60Hz
Hipot rating(Line-to-line)	1450VDC
Hipot rating(Line-to-ground)	2250VDC
Operating temperature	-25~+85°C
Safety compliance	YC series (UL,CSA,CE) : YD series (UL,CSA,VDE,CE)

\*UL, CSA except YC (10A), YD (10A)

## Typical electrical schematic

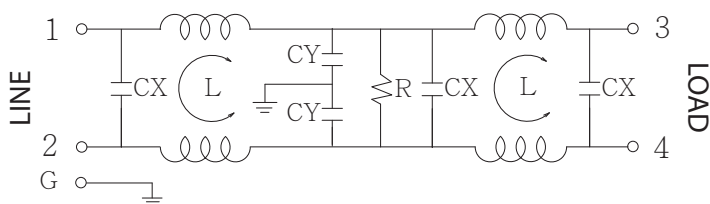

## Filter Selection Table

Part No.	Rated Current (A)	Inductance L(mH)	Capacitance CX(μF)	Capacitance CY(pF)	Resistance R(ohm)	Output connections
YC01T1L2	1	3.7	0.1	3300	10M	Fast-on terminal
YC03T1L2	3	1.8	0.1	3300	10M	
YC06T1L2	6	0.7	0.1	3300	10M	
YC10T1L2	10	0.3	0.1	3300	10M	
YD01T4L2	1	3.7	0.1	3300	10M	M4 Screw terminals
YD03T4L2	3	1.8	0.1	3300	10M	
YD06T4L2	6	0.7	0.1	3300	10M	
YD10T4L2	10	0.3	0.1	3300	10M	

## Physical Dimensions: (mm)

YC-T1L2

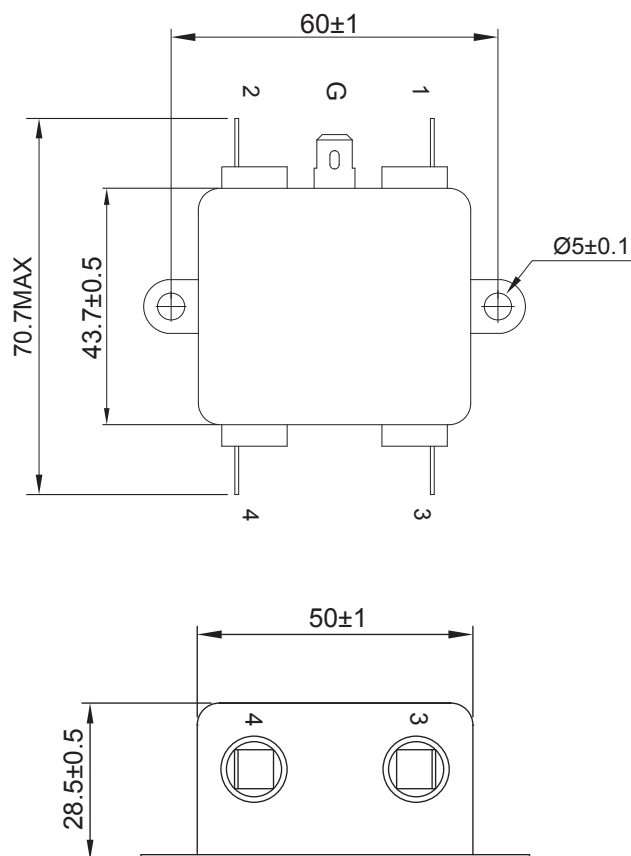

YD-T4L2

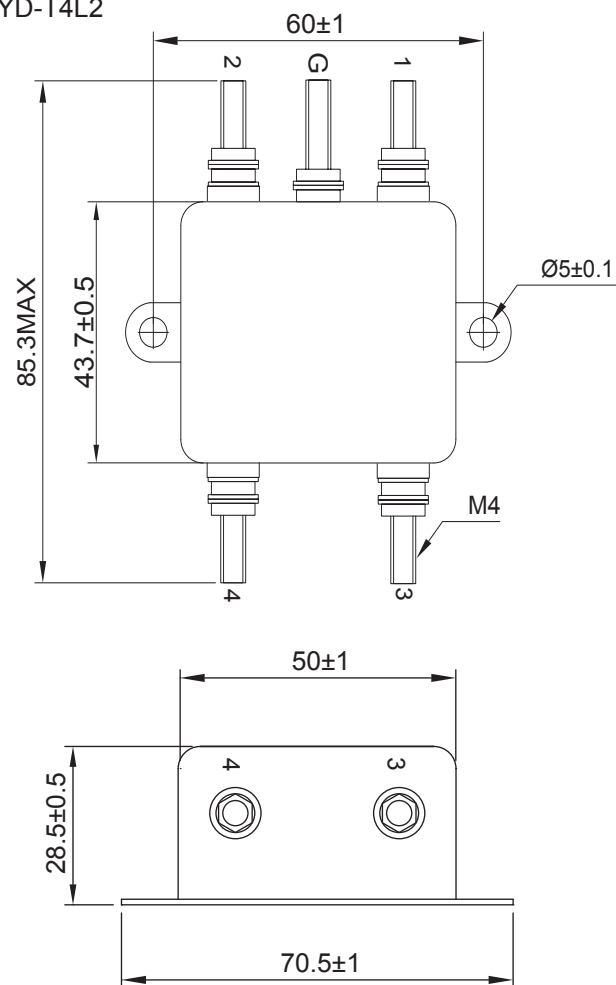

## Typical filter attenuation (Common mode — Normal mode —)

YC, YD-1

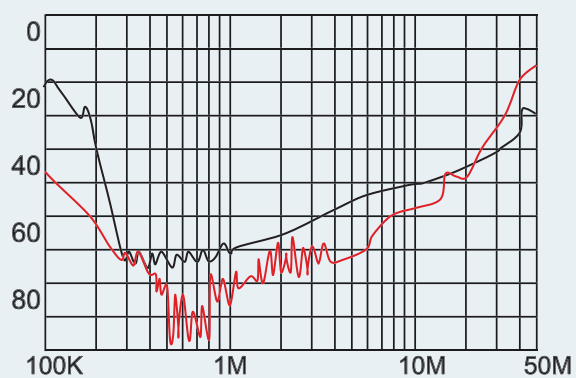

YC, YD-03

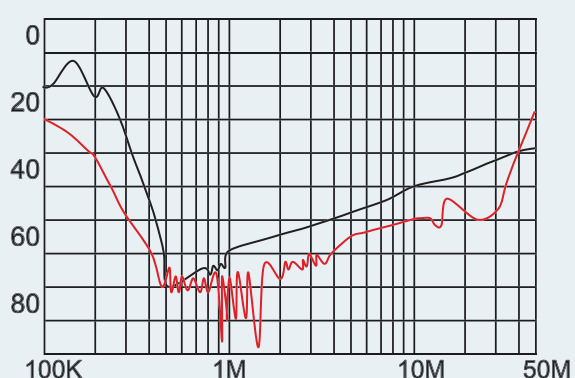

YC, YD-06

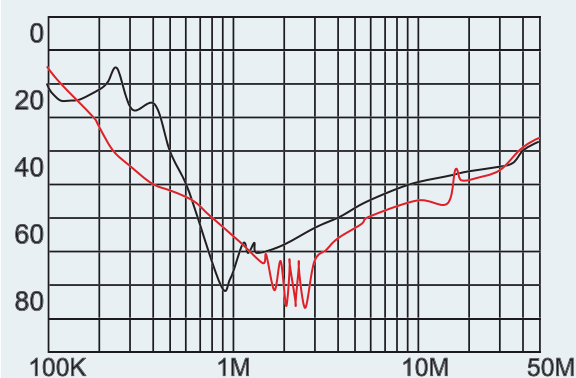

YC, YD-10

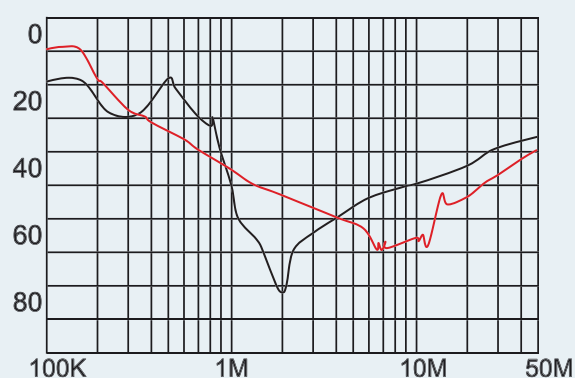

# YE SERIES (Single Phase One-Stage Filters)



## Features

- The YE series is a special designed single phase one-stage filter with both common mode and normal mode performing high noise suppression.
- The rated current can be offered from 5 to 30 amps.
- Various output selections such as fast-on terminal, M4 screw terminals and lead wire.
- Low leakage current version upon requested.
- Approved by UL ,CSA ,VDE and CE
- Application for Electrical and electronic equipment, Household equipment, Automation equipment, Fitness machine
- Custom-specific versions are available on request.

## Technical Specification

Rated voltage	125/250VAC
Rated currents	Up to 30A
Operating frequency	50/60Hz
Hipot rating(Line-to-line)	1450VDC
Hipot rating(Line-to-ground)	2250VDC
Operating temperature	-25~+85°C
Safety compliance	5A (UL,CSA) : 5 to 30A (VDE, CE)

## Typical electrical schematic

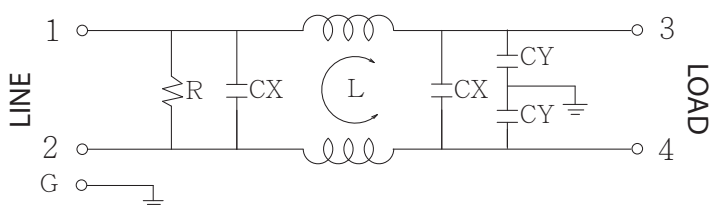

## Filter Selection Table

Part NO.	Rated Current (A)	Inductance L(mH)	Capacitance CX(μF)	Capacitance CY(pF)	Resistance R(ohm)	Output connections
YE05T1	5	5	0.1	3300	10M	Fast-on terminal (optional lead-wire)
YE10T1	10	3	0.1	3300	10M	
YE15T1	15	2	0.1	3300	10M	
YE20T1	20	0.9	0.1	3300	10M	
YE30T1	30	0.5	0.1	3300	10M	
YE05T4	5	5	0.1	3300	10M	M4 Screw terminals
YE10T4	10	3	0.1	3300	10M	
YE15T4	15	2	0.1	3300	10M	
YE20T4	20	0.9	0.1	3300	10M	
YE30T4	30	0.5	0.1	3300	10M	

## Physical Dimensions: (mm)

YE-T1

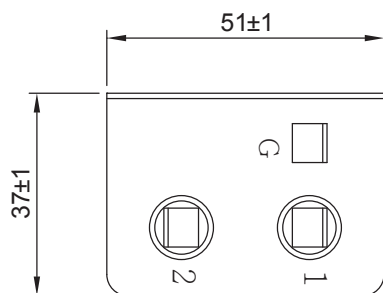
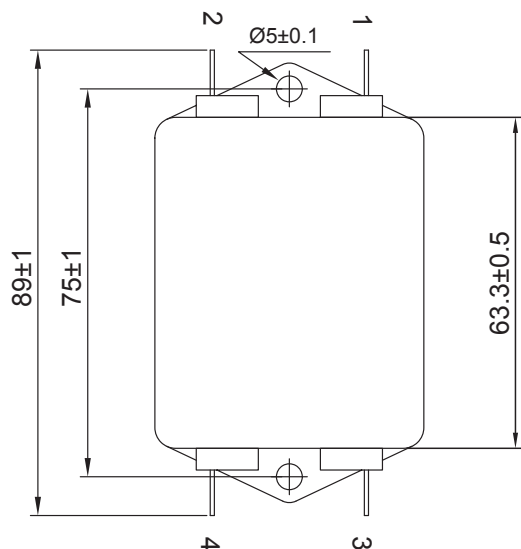

YE-T4

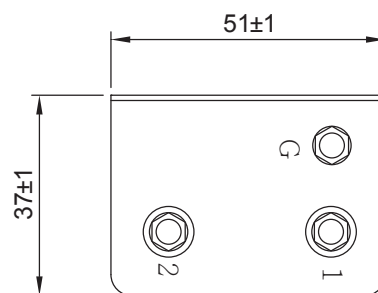
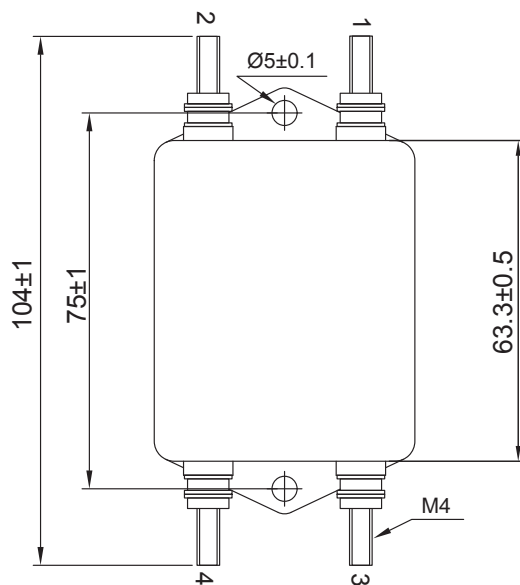

## Typical filter attenuation (Common mode — Normal mode —)

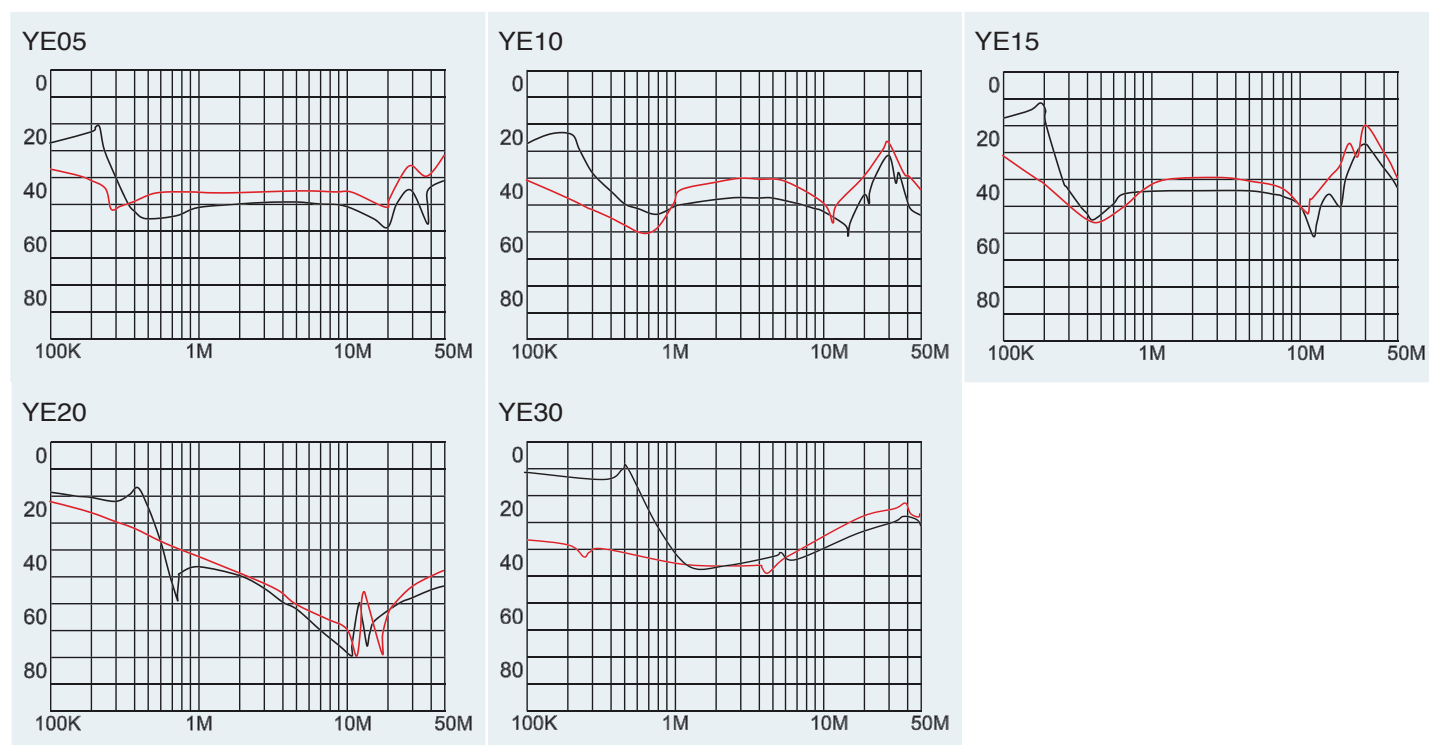

# YE-L2 SERIES (Single Phase Two-Stage Filters)



## Features

- The YE series is a special designed single phase two-stage filter with both common mode and normal mode performing high noise suppression for most digital electronic equipment.
- The rated current can be offered from 5 to 20 amps.
- Various output selections such as fast-on terminal, M4 screw terminals and lead wire.
- Low leakage current version upon requested.
- Approved by UL, CSA, VDE and CE
- Application for Electrical and electronic equipment, Household equipment, Automation equipment, Fitness machine, Various noisy applications requiring high filter performance
- Custom-specific versions are available on request.

## Technical Specification

Rated voltage	125/250VAC
Rated currents	Up to 20A
Operating frequency	50/60Hz
Hipot rating(Line-to-line)	1450VDC
Hipot rating(Line-to-ground)	2250VDC
Operating temperature	-25~+85°C
Safety compliance	UL,CSA,VDE,CE

## Typical electrical schematic

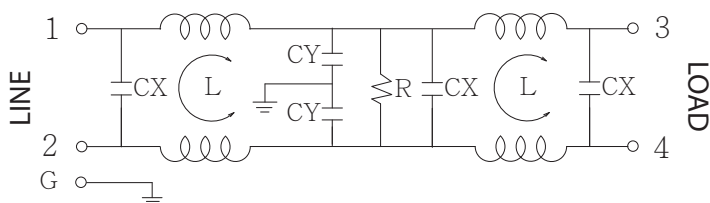

## Filter Selection Table

Part No.	Rated Current (A)	Inductance L(mH)	Capacitance CX(μF)	Capacitance CY(pF)	Resistance R(ohm)	Output connections
YE05T1L2	5	5	0.1	3300	10M	Fast-on terminal (optional lead-wire)
YE10T1L2	10	1.2	0.1	3300	10M	
YE15T1L2	15	0.9	0.1	3300	10M	
YE20T1L2	20	0.5	0.1	3300	10M	
YE05T4L2	5	5	0.1	3300	10M	M4 Screw terminals
YE10T4L2	10	1.2	0.1	3300	10M	
YE15T4L2	15	0.9	0.1	3300	10M	
YE20T4L2	20	0.5	0.1	3300	10M	

## Physical Dimensions: (mm)

YE-T1L2

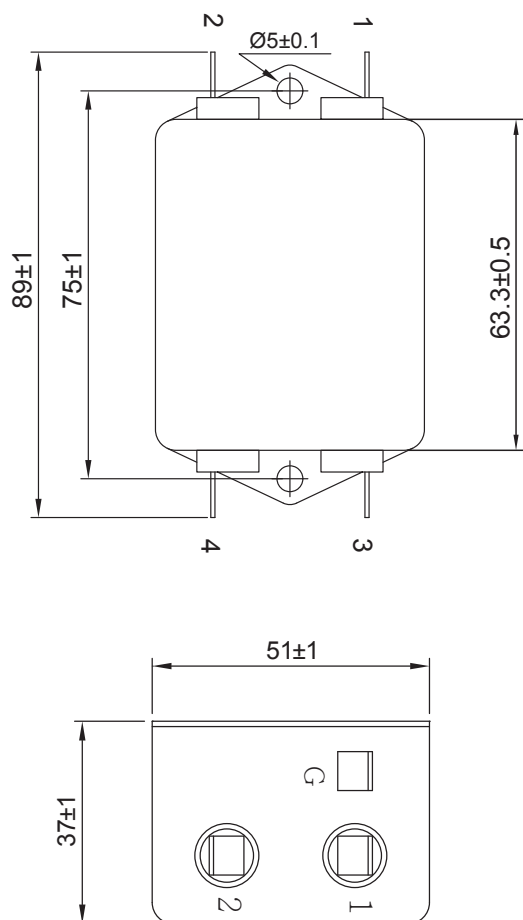

YE-T4L2

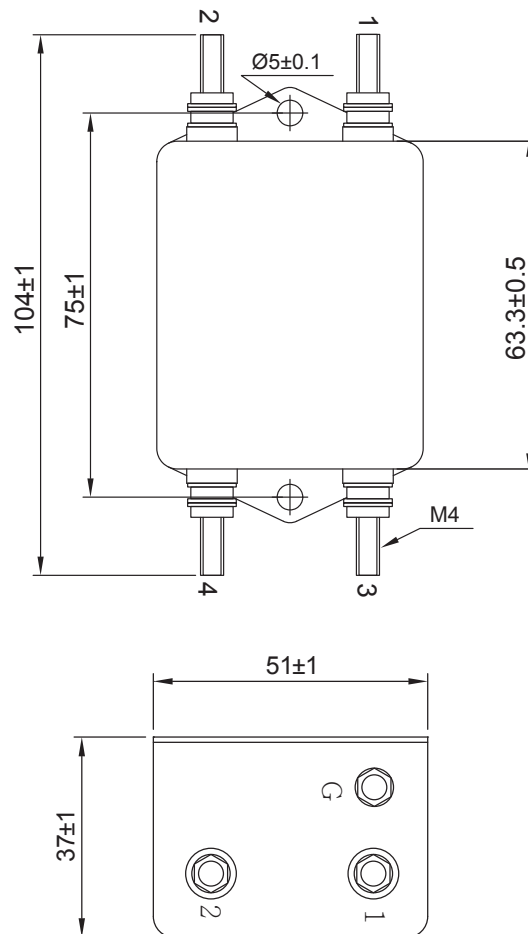

## Typical filter attenuation (Common mode — Normal mode —)

YE05-L2

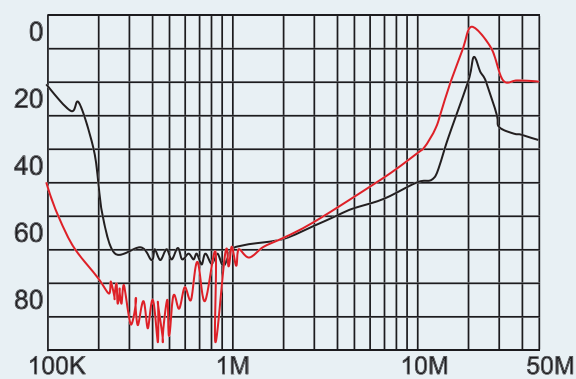

YE10-L2

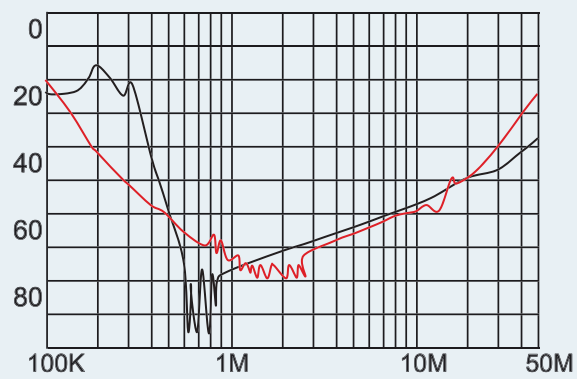

YE15-L2

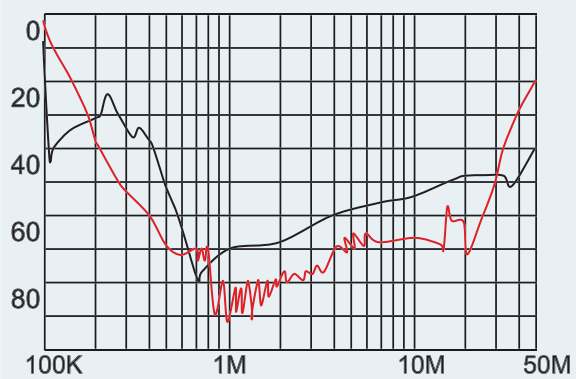

YE20-L2

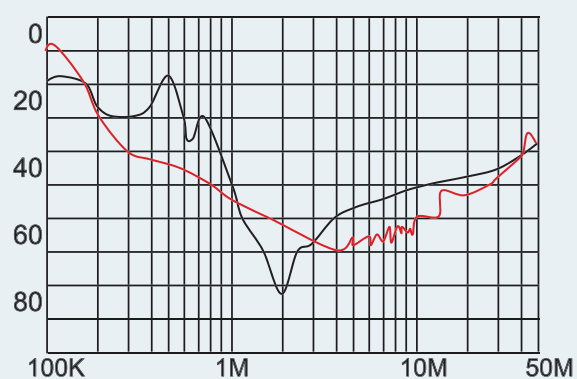

# YF-T6, T8 SERIES (PC Board Mounting Filters)



## Features

- Specially designed for easy PC Board mounting filtering with plastic case.
- The rated current can be offered up to 10 amps.
- Low leakage current version upon requested.
- Approved by UL, CSA, VDE and CE
- Applications comprising Household equipment , Medical equipment, Test and measurement equipment, datacom equipment, automation equipment
- Custom-specific versions are available on request.

## Technical Specification

Rated voltage	125/250VAC
Rated currents	1 to 10A
Operating frequency	50/60Hz
Hipot rating(Line-to-line)	1450VDC
Hipot rating(Line-to-ground)	2250VDC
Operating temperature	-25~+85°C
Safety compliance	T6 Series(UL,CSA,VDE,CE), T8 Series(VDE,CE)

## Typical electrical schematic

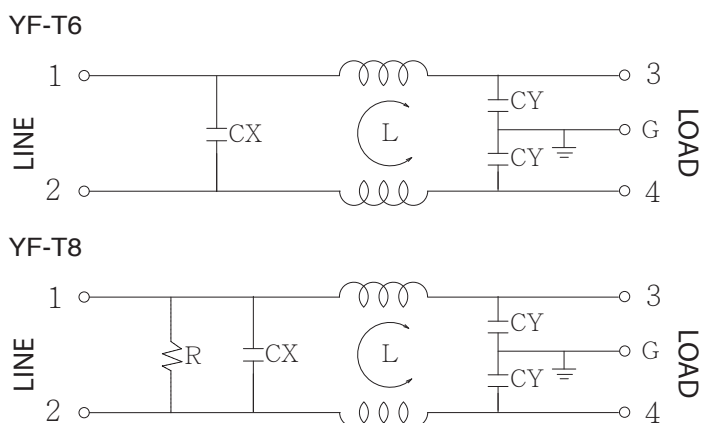

## Filter Selection Table

Part No.	Rated Current (A)	Inductance L(mH)	Capacitance CX( $\mu$ F)	Capacitance CY(pF)	Resistance R(ohm)	Output connections
YF01T6	1	3.7	0.1	3300	-	PCB terminal
YF03T6	3	1.8	0.1	3300	-	
YF06T6	6	0.7	0.1	3300	-	
YF10T6	10	0.3	0.1	3300	-	
YF01T8	1	3.7	0.1	3300	1.5M	
YF03T8	3	1.8	0.1	3300	1.5M	
YF06T8	6	0.7	0.1	3300	1.5M	
YF10T8	10	0.3	0.1	3300	1.5M	

## Physical Dimensions: (mm)

YF-T6

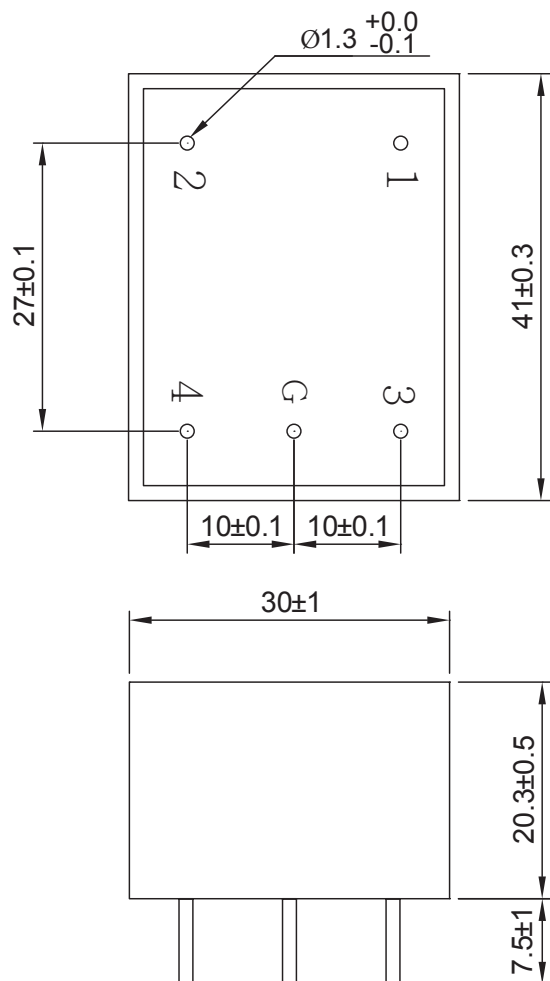

YF-T8

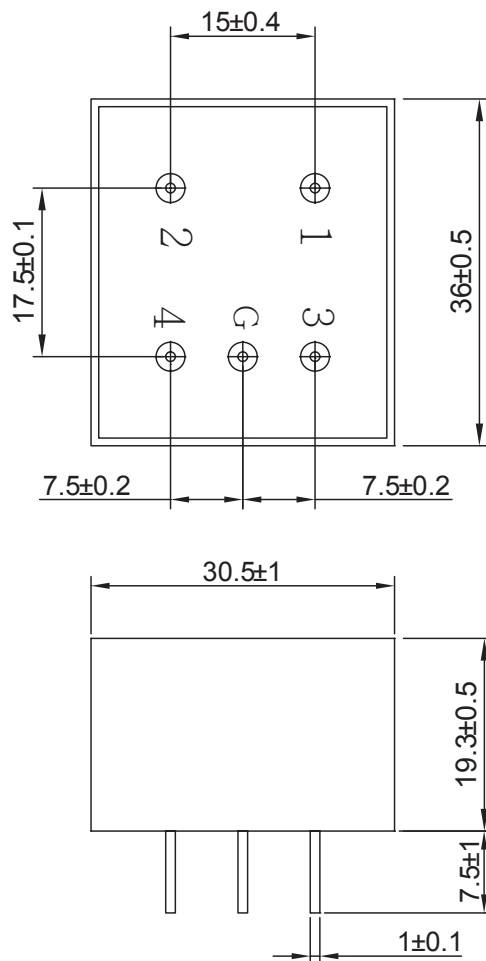

## Typical filter attenuation (Common mode — Normal mode —)

YF01

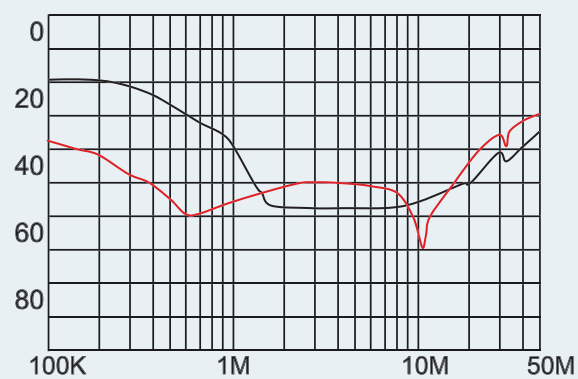

YF03

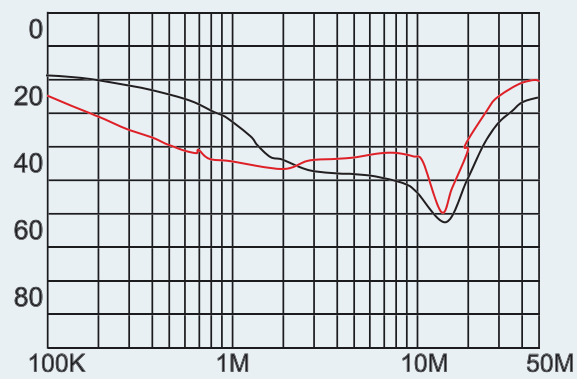

YF06

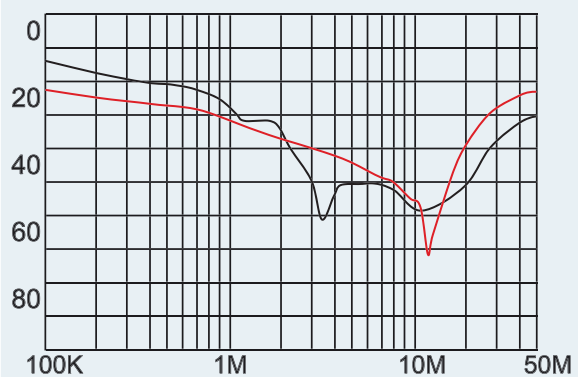

YF10

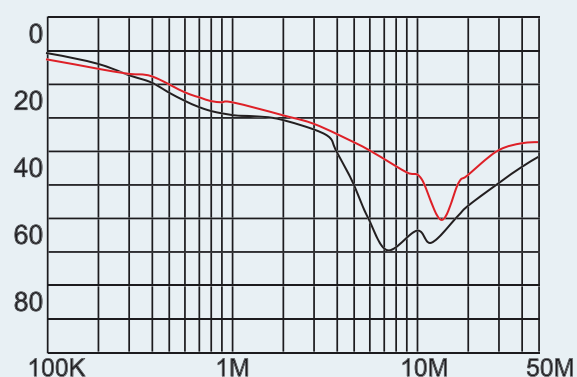



# YF-T12 SERIES (PC Board Mounting Filters)



## Features

- Direct PC Board mounting for easy installation and compact for space saving, the reliable plastic cover at low cost.
- The rated current can be offered from 0.5 to 10 amps.
- Low leakage current version upon requested.
- All parts are approved by UL, CE
- Applications comprising Household equipment , Medical equipment, Test and measurement equipment, datacom equipment, automation equipment
- Custom-specific versions are available on request.

## Technical Specification

Rated voltage	125/250VAC
Rated currents	Up to 10A
Operating frequency	50/60Hz
Hipot rating(Line-to-line)	1450VDC
Hipot rating(Line-to-ground)	2250VDC
Operating temperature	-25~+85°C
Safety compliance	UL, CE

## Typical electrical schematic

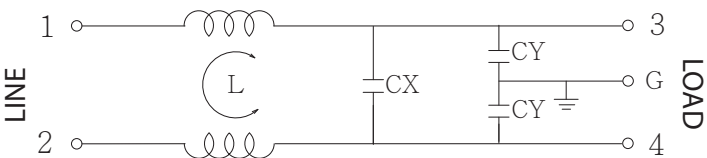

## Filter Selection Table

Part No.	Rated Current (A)	Inductance L(mH)	Capacitance CX( $\mu$ F)	Capacitance CY(pF)	Output connections
YF0R5T12	0.5	40	0.1	2500	PCB terminal
YF1R5T12	1.5	6	0.1	2500	
YF2R5T12	2.5	2	0.1	2500	
YF6R5T12	6.5	1	0.1	2500	
YF10T12	10	0.3	0.1	2500	

## YF-T12

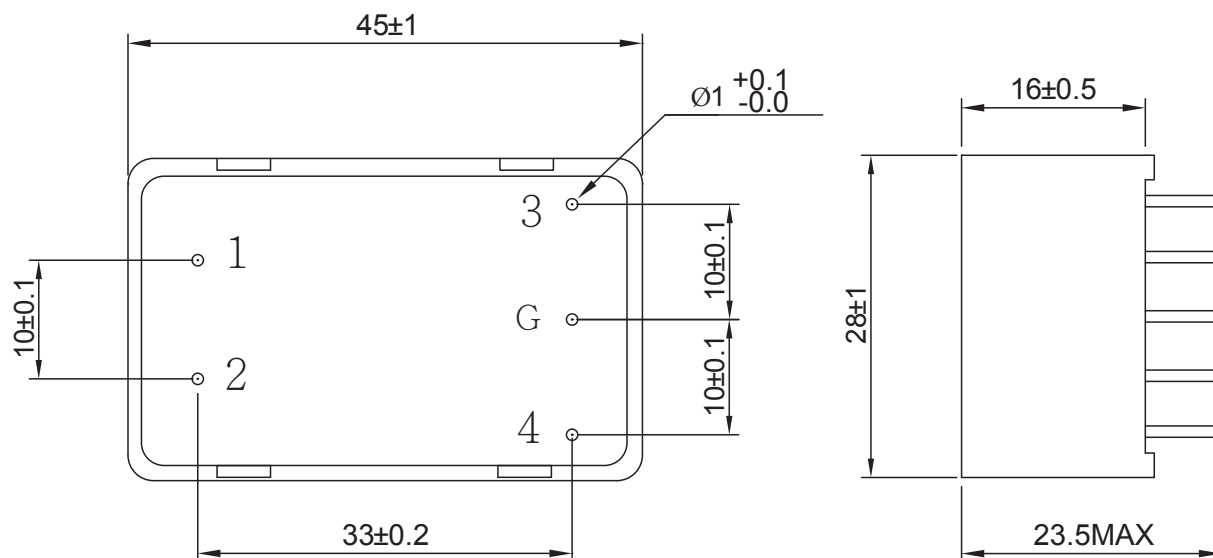

## YF0R5

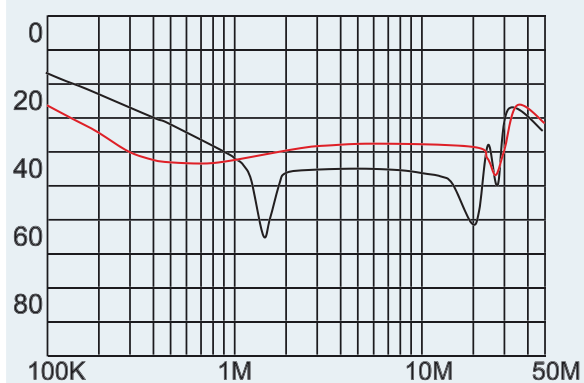

YF2R5

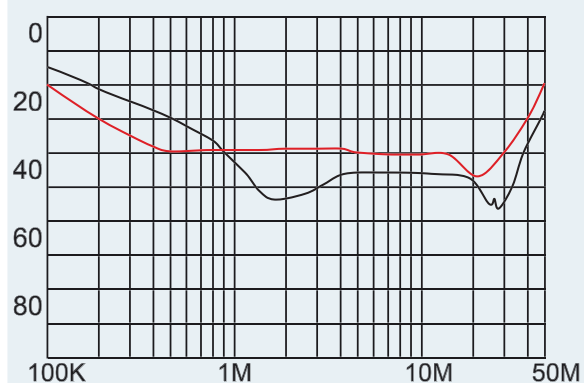

YF10

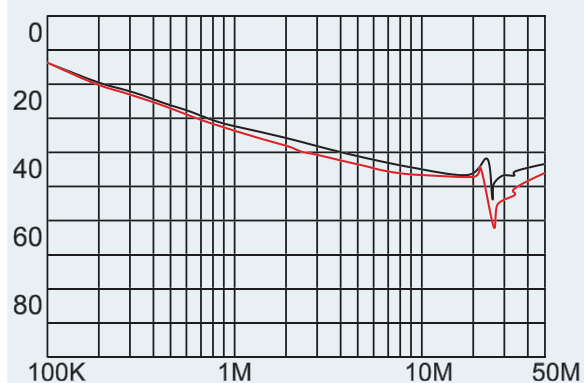

YF1R5

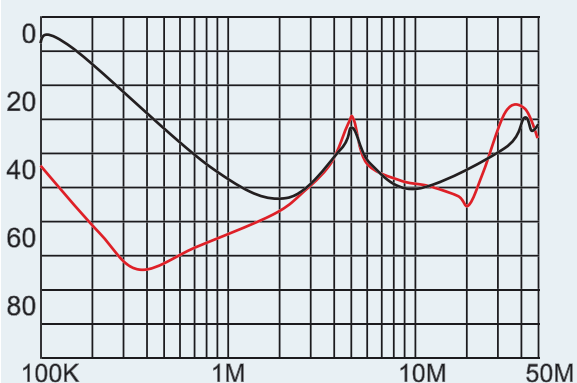

YF6R5

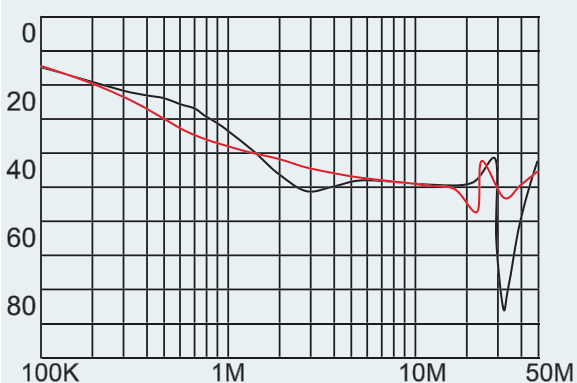

# YG-T5, T13 SERIES (Plastic Case Single Phase Filters)



## Features

- General purpose filter with plastic case.
- Flammability corresponding to UL 94 V-0.
- Its rated current can be offered from 0.5 to 10 amps.
- T5 series are approved by UL and CSA; T13 series are approved by UL.
- Easy installation and compact for space saving, the reliable plastic cover at low cost.
- Applications comprising Small to medium-sized machines and household equipment, Medical equipment, datacom equipment, Test and measurement equipment.
- Custom-specific versions are available on request.

## Technical Specification

Rated voltage	125/250VAC
Rated currents	0.5 to 10A
Operating frequency	50/60Hz
Hipot rating(Line-to-line)	1450VDC
Hipot rating(Line-to-ground)	2250VDC
Operating temperature	-25~+85°C
Safety compliance	T5(UL,CSA,CE) T13(UL,CE)

## Typical electrical schematic

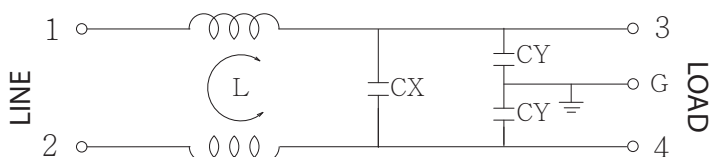

## Filter Selection Table

Part No.	Rated Current (A)	Inductance L(mH)	Capacitance CX(μF)	Capacitance CY(pF)	Output connections
YG01T5	1	3.7	0.1	3300	3mm terminal
YG03T5	3	1.8	0.1	3300	
YG06T5	6	0.7	0.1	3300	
YG10T5	10	0.3	0.1	3300	
YG0R5T13	0.5	40	0.1	2500	PCB terminal
YG1R5T13	1.5	6	0.1	2500	
YG2R5T13	2.5	2	0.1	2500	
YG6R5T13	6.5	1	0.1	2500	
YG10T13	10	0.3	0.1	2500	

## Physical Dimensions: (mm)

YG-T5

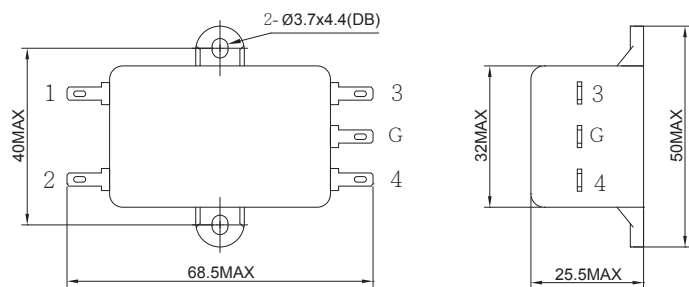

YG-T13

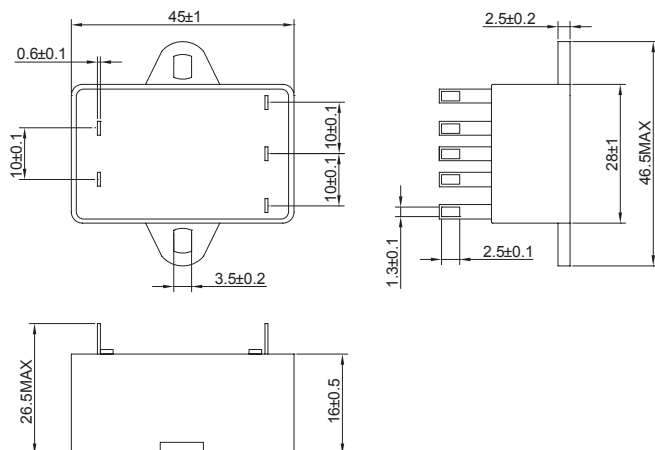

## Typical filter attenuation (Common mode — Normal mode —)

YG01

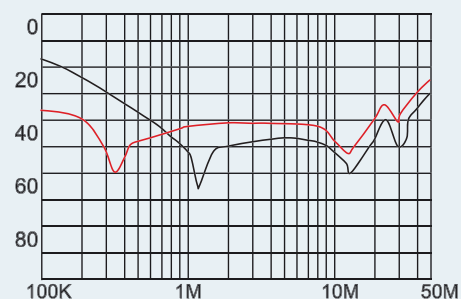

YG03

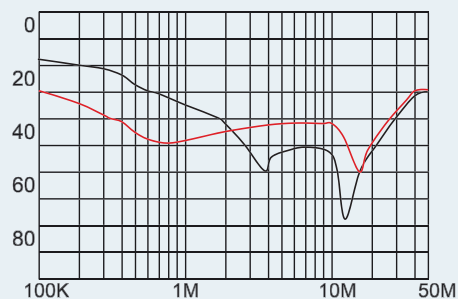

YG06

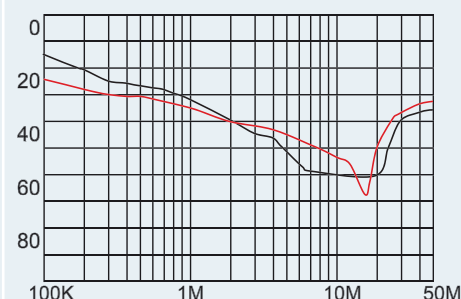

YG10

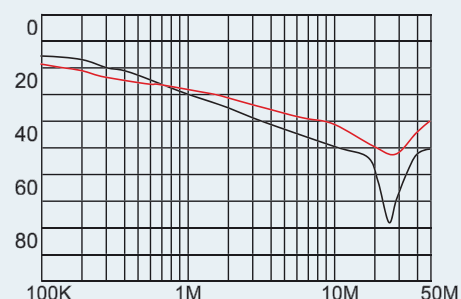

YG0R5

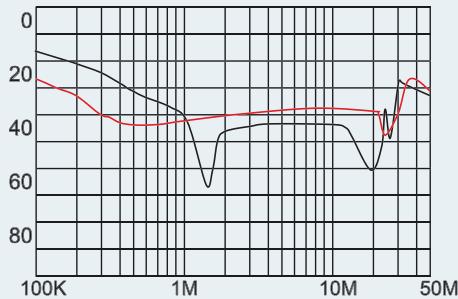

YG1R5

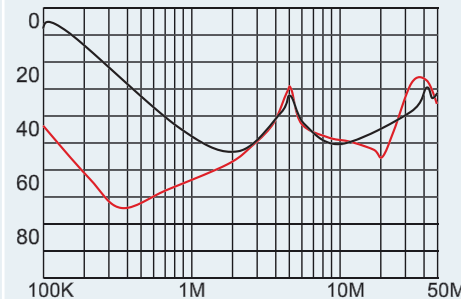

YG02

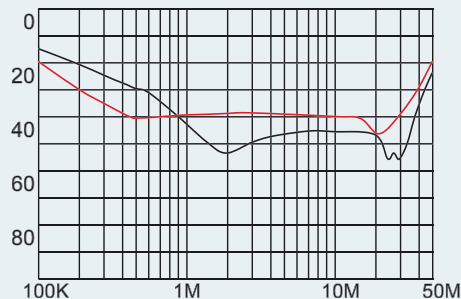

YG06

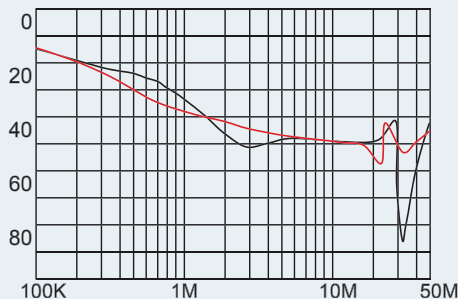

YG10

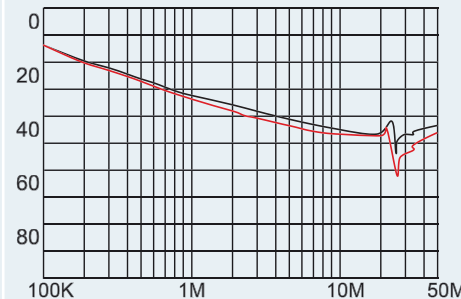

# YH SERIES (3-Phase 3-Wire Filters)



## Features

- Good noise attenuation in both forward and reverse directions for common mode and normal mode.
- High reliability designed for industrial equipment usage with 3-phase 3-wire filter.
- The rated current can be offered from 10 to 30 amp in both 250VAC and 500VAC versions.
- M4 Screw Terminals for output is designed for easy installation.
- Applications comprising frequency inverters, motor drives and servo drives, Three-phase applications automation equipment.

## Technical Specification

Rated voltage	125/250VAC, 250/500VAC
Rated currents	up to 30A
Operating frequency	50/60Hz
Hipot rating(Line-to-line)	1450VDC
Hipot rating(Line-to-ground)	2250VDC
Operating temperature	-25~+85°C
Safety compliance	CE

## Typical electrical schematic

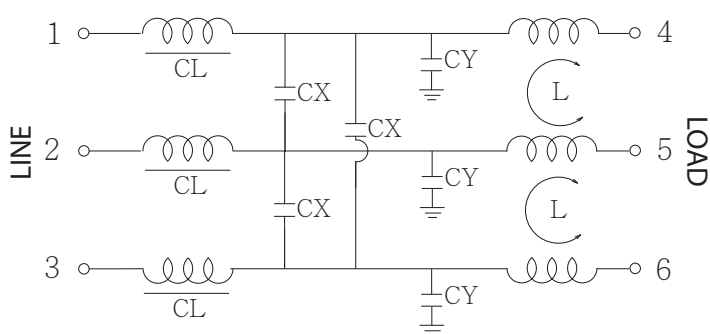

## Filter Selection Table

Part No.	Rated Current (A)	Inductance CL(mH)	Inductance L(mH)	Capacitance CX(μF)	Capacitance CY(pF)	Output connections
YH10T4	10	0.9	1.45	0.2	3300	M4 Screw terminals
YH15T4	15	0.74	0.7	0.2	3300	
YH20T4	20	0.46	0.51	0.2	3300	
YH30T4	30	0.35	0.36	0.2	3300	
YH10T4-1	10	0.9	1.45	0.2	3300	
YH15T4-1	15	0.74	0.7	0.2	3300	
YH20T4-1	20	0.46	0.51	0.2	3300	
YH30T4-1	30	0.35	0.36	0.2	3300	

\*blank:125/250VAC;-1:250/500VAC

## Physical Dimensions: (mm)

YH-T4

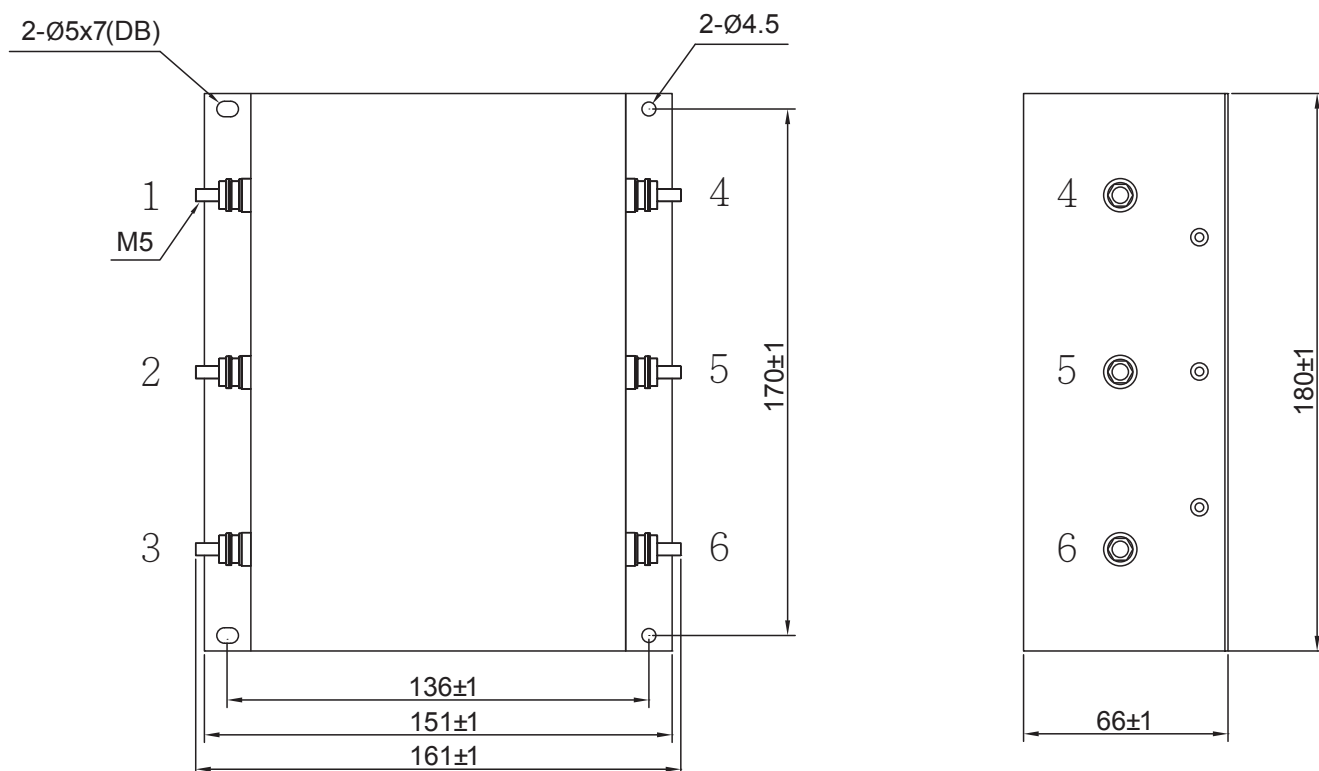

## Typical filter attenuation (Common mode — Normal mode —)

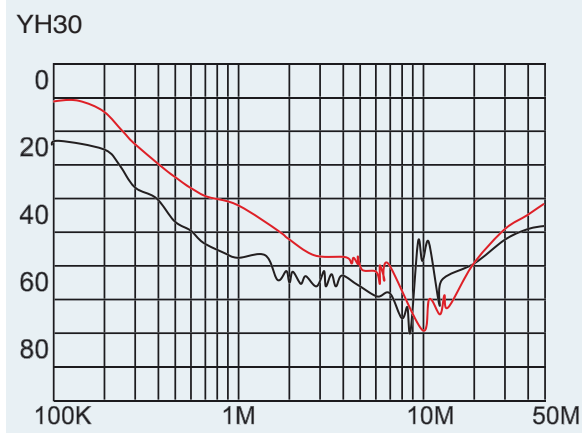
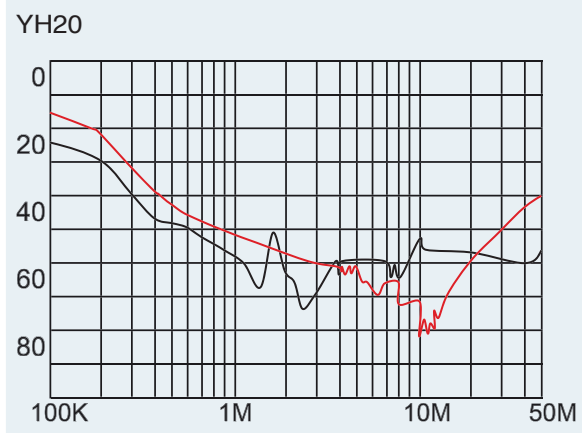
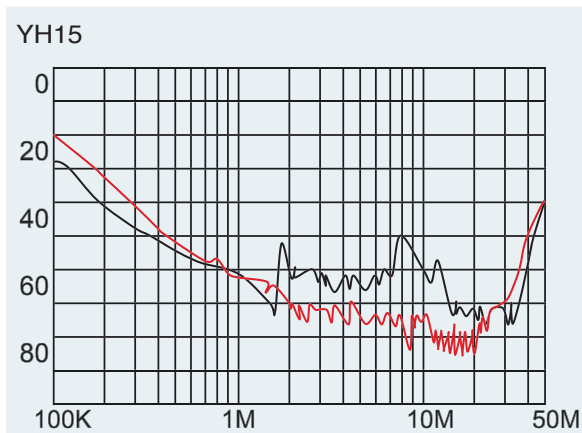
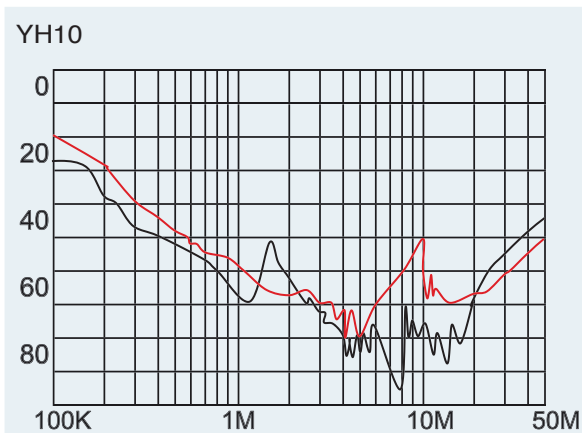

# YI SERIES (3-Phase 3-Wire Filters)



## Features

- Good noise attenuation in both forward and reverse directions for common mode and normal mode.
- High reliability designed for industrial equipment usage with 3-phase 3-wire filter.
- The rated current can be offered from 40 to 60 amp in both 250VAC and 500VAC versions.
- M5 Screw Terminals for output is designed for easy installation.
- Applications comprising frequency inverters, motor drives and servo drives, Three-phase applications automation equipment.

## Technical Specification

Rated voltage	125/250VAC, 250/500VAC
Rated currents	40 to 60A
Operating frequency	50/60Hz
Hipot rating(Line-to-line)	1450VDC
Hipot rating(Line-to-ground)	2250VDC
Operating temperature	-25~+85°C
Safety compliance	CE

## Typical electrical schematic

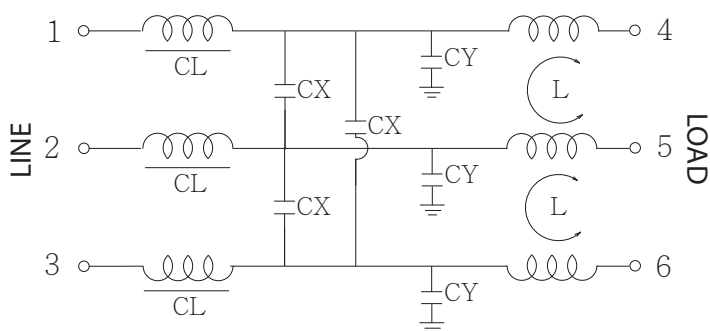

## Filter Selection Table

Part No.	Rated Current (A)	Inductance CL(mH)	Inductance L(mH)	Capacitance CX(μF)	Capacitance CY(pF)	Output connections
YI40T7	40	0.25	0.93	0.2	3300	M5 Screw terminals
YI50T7	50	0.11	0.73	0.2	3300	
YI60T7	60	0.11	0.41	0.2	3300	
YI40T7-1	40	0.25	0.93	0.2	3300	
YI50T7-1	50	0.11	0.73	0.2	3300	
YI60T7-1	60	0.11	0.41	0.2	3300	

\*blank:125/250VAC;-1:250/500VAC

## Physical Dimensions: (mm)

YI-T7

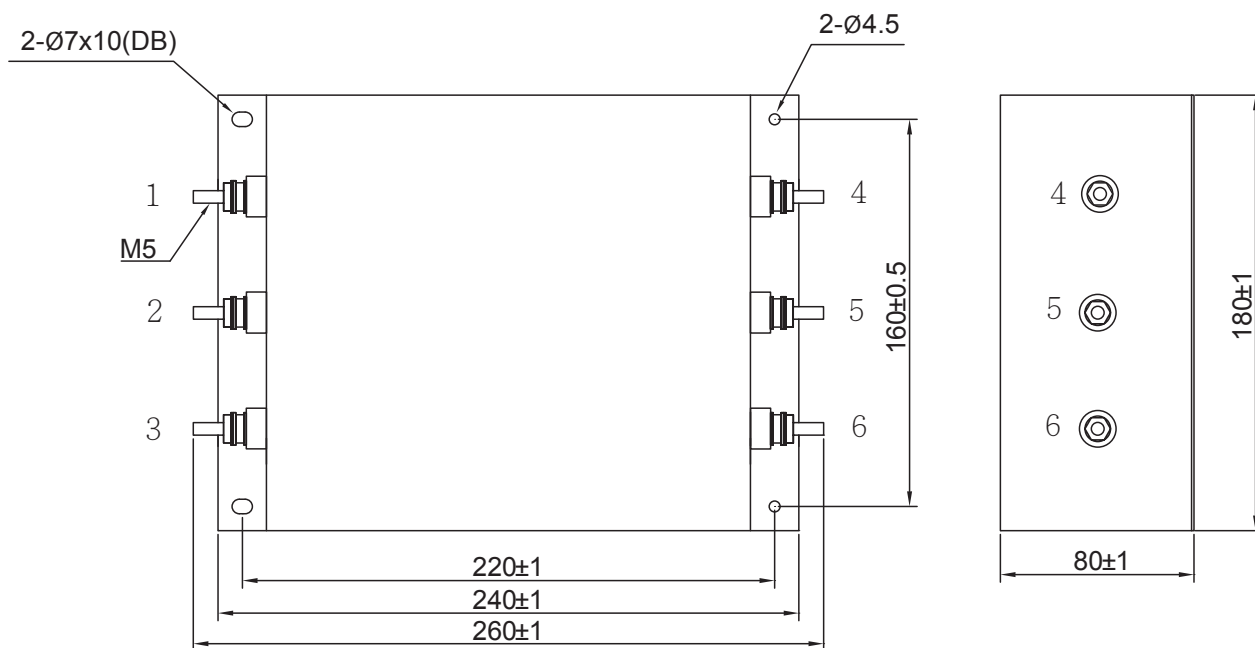

## Typical filter attenuation (Common mode — Normal mode —)

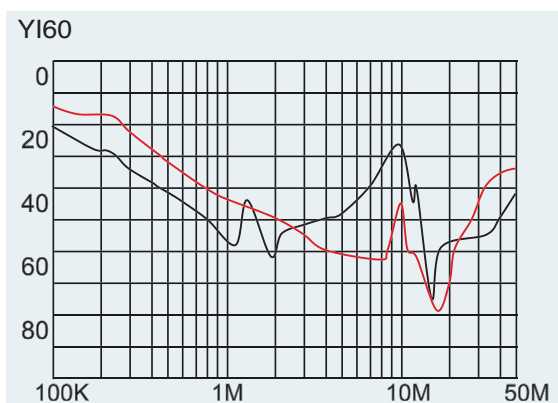
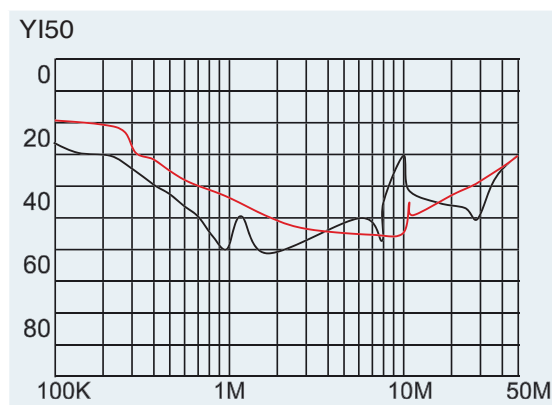
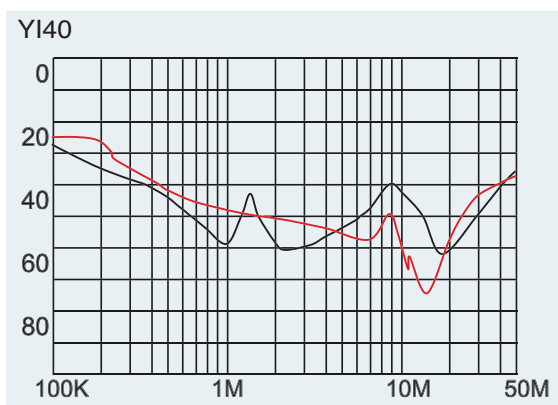



# YJ SERIES (Single Phase Filters)



## Features

- Good noise attenuation in both forward and reverse directions for common mode and normal mode.
- High reliability designed for industrial equipment usage with single phase filter.
- The rated current can be offered from 30 to 60 amps in both 250VAC and 500VAC versions.
- M5 Screw Terminals for output is designed for easy installation.
- Applications comprising various industrial applications comprising frequency inverters, motor drives and servo drives

## Technical Specification

Rated voltage	250VAC, 250/500VAC
Rated currents	30 to 60A
Operating frequency	50/60Hz
Hipot rating(Line-to-line)	1450VDC
Hipot rating(Line-to-ground)	2250VDC
Operating temperature	-25~+85°C
Safety compliance	CE

## Typical electrical schematic

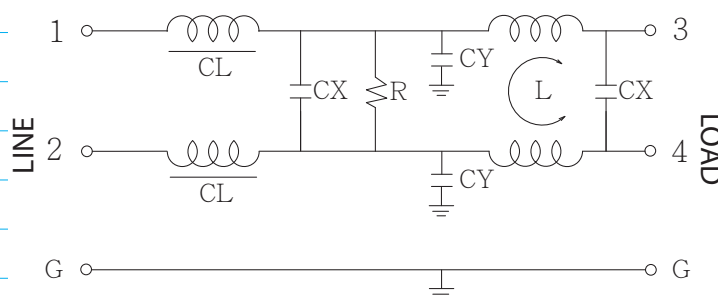

## Filter Selection Table

Part No.	Rated Current (A)	Inductance CL(mH)	Inductance L(mH)	Capacitance CX(μF)	Capacitance CY(pF)	Resistance R(ohm)	Output connections
YJ30T7	30	0.35	3.7	0.2	3300	10M	M5 Screw terminals
YJ40T7	40	0.35	2.6	0.2	3300	10M	
YJ50T7	50	0.11	1.7	0.2	3300	10M	
YJ60T7	60	0.11	1.2	0.2	3300	10M	
YJ30T7-1	30	0.35	3.7	0.2	3300	10M	
YJ40T7-1	40	0.35	2.6	0.2	3300	10M	
YJ50T7-1	50	0.11	1.7	0.2	3300	10M	
YJ60T7-1	60	0.11	1.2	0.2	3300	10M	

\*blank:125/250VAC;-1:250/500VAC

## Physical Dimensions: (mm)

YJ-T7

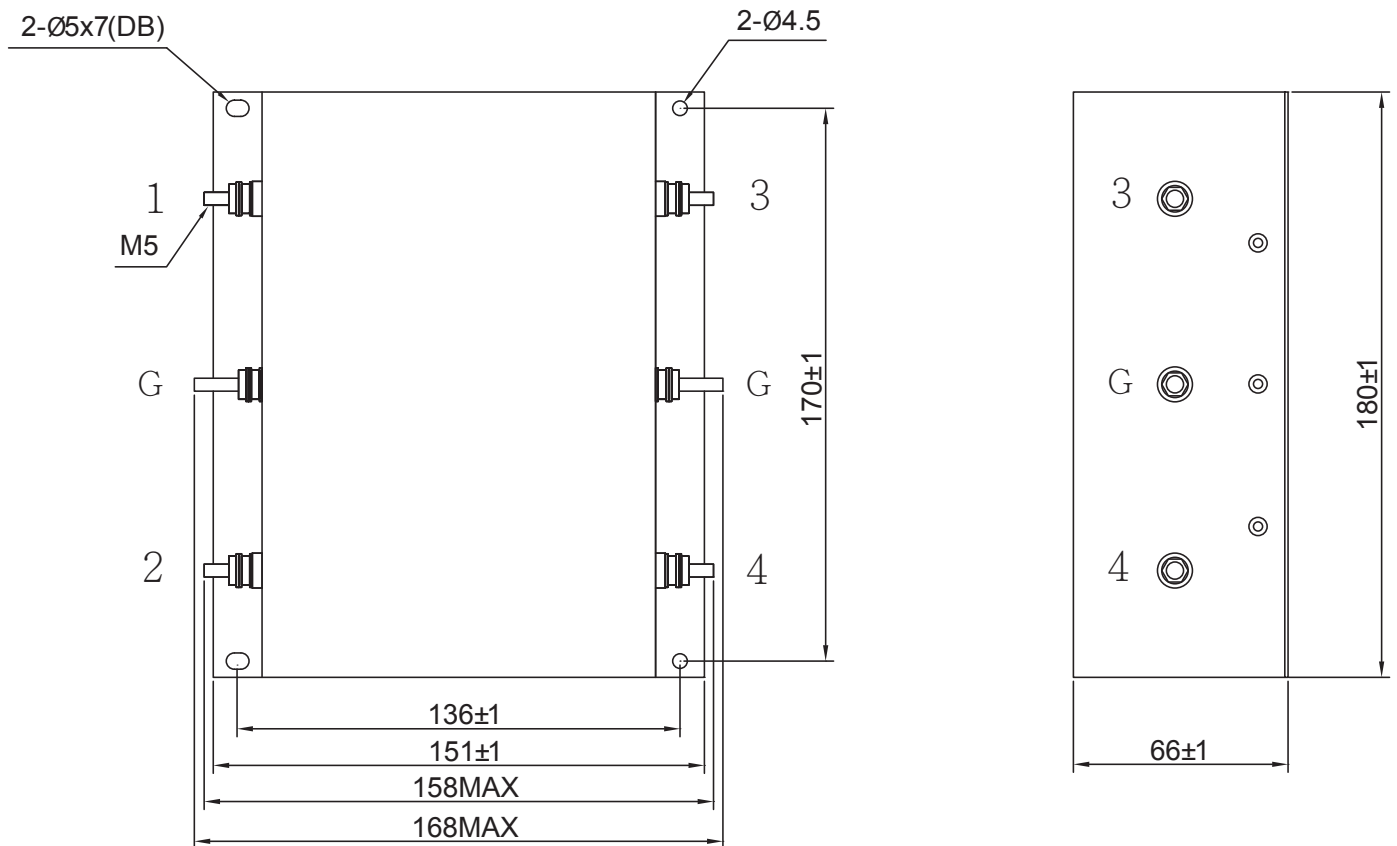

## Typical filter attenuation (Common mode — Normal mode —)

YJ30

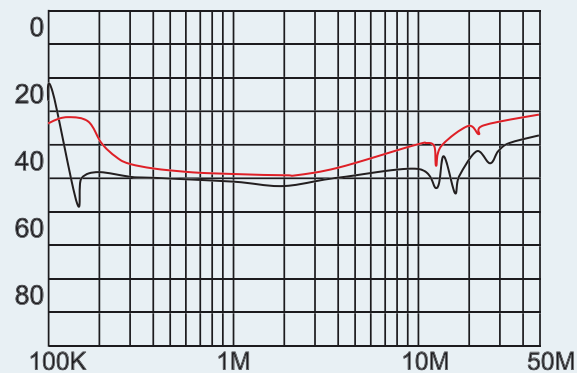

YJ40

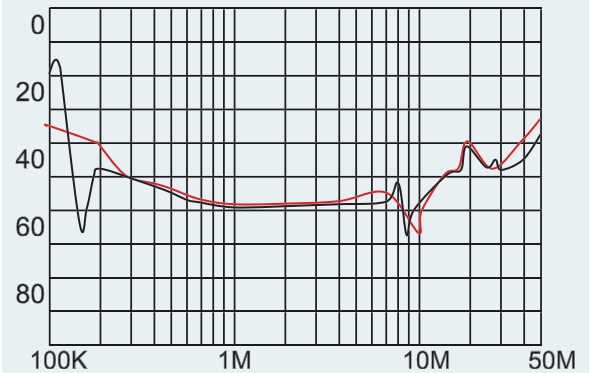

YJ50

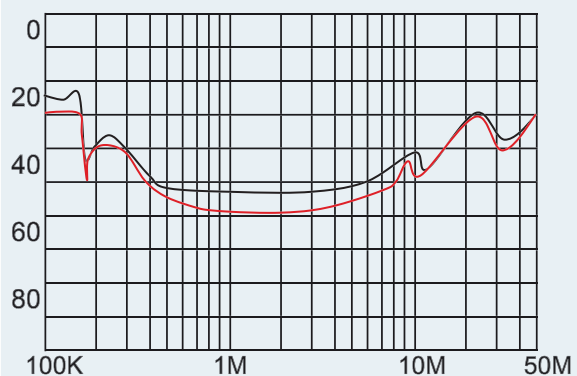

YJ60

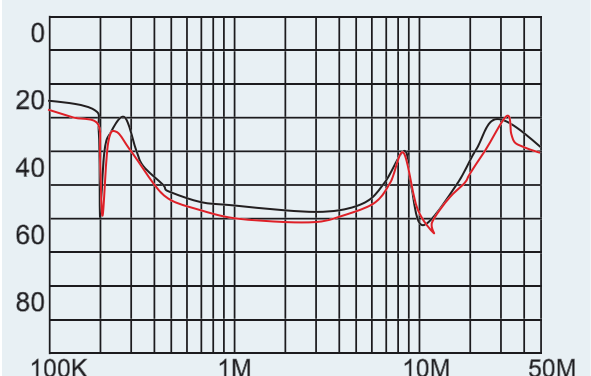

# YK SERIES (Single Phase Filters)



## Features

- The YK series is general purpose single phase filter.
- The rated current can be offered from 1 to 10 amps.
- The compact size for easy installation and space saving.
- Various output selections such as fast-on terminal, and lead wire.
- Low leakage current version upon requested.
- All parts are approved by UL ,CSA ,VDE and CE
- Applications comprising Electrical and electronic equipment, household equipment, Medical equipment, Datacom equipment, Test and measurement equipment, Fitness machine.

## Technical Specification

Rated voltage	125/250VAC
Rated currents	1 to 10A
Operating frequency	50/60Hz
Hipot rating(Line-to-line)	1450VDC
Hipot rating(Line-to-ground)	2250VDC
Operating temperature	-25~+85°C
Safety compliance	UL,CSA,VDE,CE

## Typical electrical schematic

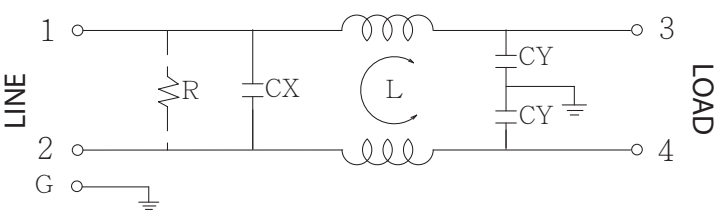

\*With optional ground choke and resister.  
R: 1M ohm, 1/4W min.

## Filter Selection Table

Part No.	Rated Current (A)	Inductance L(mH)	Capacitance CX(μ F)	Capacitance CY(pF)	Output connections
YK01T1	1	3.7	0.1	3300	Fast-on terminal (optional lead-wire)
YK03T1	3	1.8	0.1	3300	
YK06T1	6	0.7	0.1	3300	
YK10T1	10	0.3	0.1	3300	

## Physical Dimensions: (mm)

YK-T1

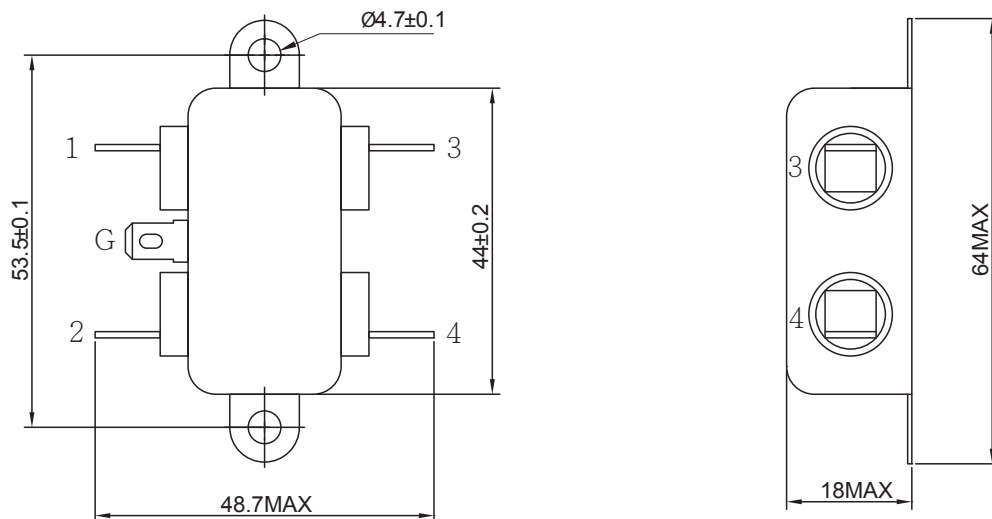

YK-T (Lead-wire)

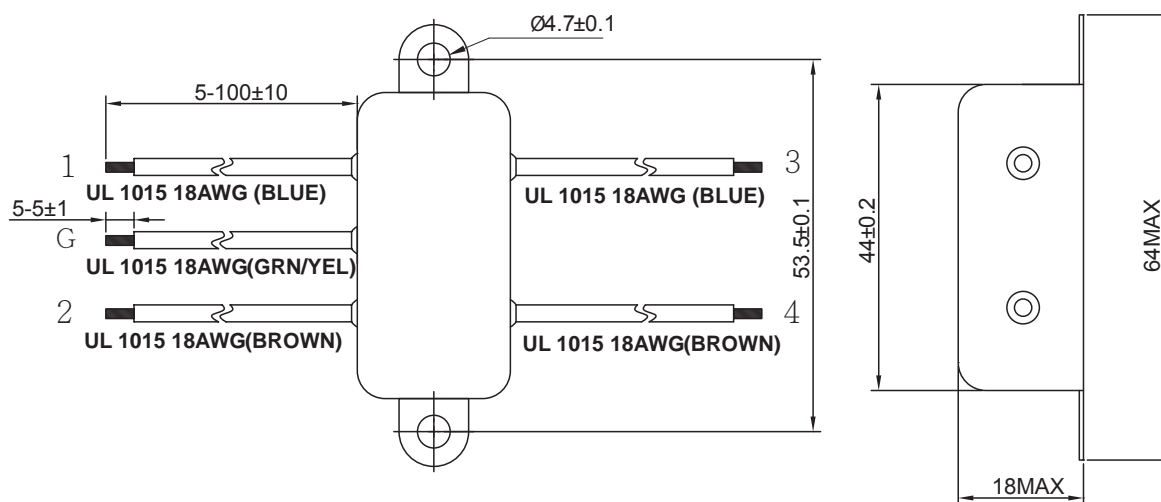

## Typical filter attenuation (Common mode — Normal mode —)

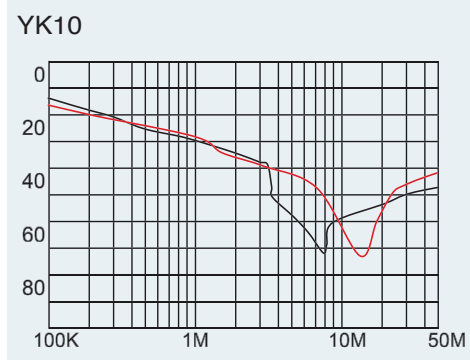
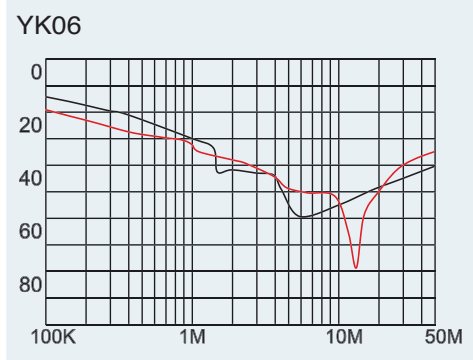
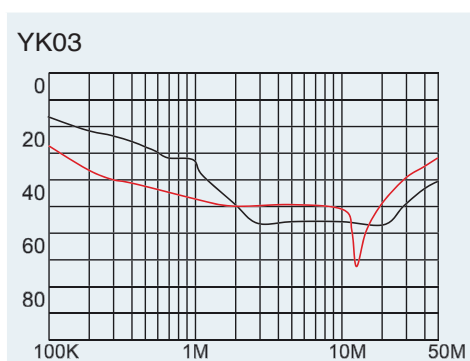
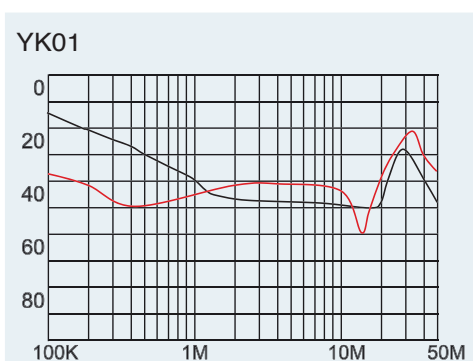

# YL SERIES (Power Entry Module Filters)



## Features

- General purpose filter with fuse holder providing effective EMI suppression of both line-to-line and line-to-ground noise
- The rated current can be offered up to 10 amps and available with single or double fuse holder(Ø 5 x 20 mm)
- Various output selections such as fast-on terminal, and lead wire.
- Low leakage current version upon requested.
- Approved by UL, CSA, VDE, CQC and CE.
- Applications comprising Electrical and electronic equipment, Household equipment, Medical equipment, Testing and Measuring equipment.
- Custom-specific versions are available on request.

## Technical Specification

Rated voltage	125/250VAC
Rated currents	1 to 10A
Operating frequency	50/60Hz
Hipot rating(Line-to-line)	1450VDC
Hipot rating(Line-to-ground)	2250VDC
Operating temperature	-25~+85°C
Safety compliance	UL,CSA,VDE,CQC,CE

\*except double fuse type

## Typical electrical schematic

YL-T1

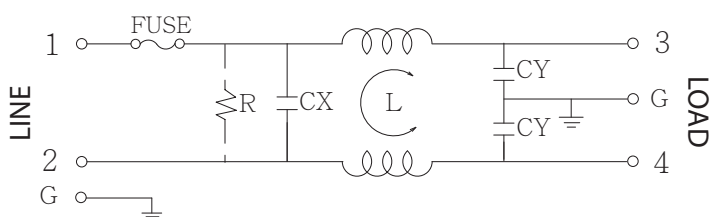

YL-T1-2F

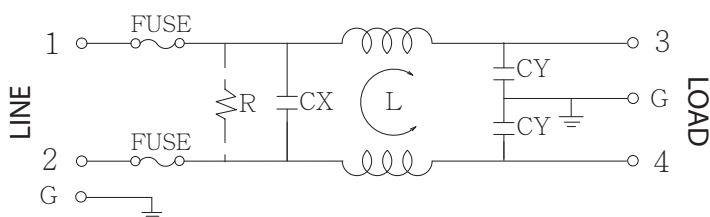

\*With optional resistor.

R: 1M ohm

## Filter Selection Table

Part No.	Rated Current (A)	Inductance L(mH)	Capacitance CX(μF)	Capacitance CY(pF)	Output connections
YL01T1	1	3.7	0.1	3300	Fast-on terminal (optional lead-wire)
YL03T1	3	1.8	0.1	3300	
YL06T1	6	0.7	0.1	3300	
YL10T1	10	0.3	0.1	3300	
YL01T1-2F	1	3.7	0.1	3300	
YL03T1-2F	3	1.8	0.1	3300	
YL06T1-2F	6	0.7	0.1	3300	
YL10T1-2F	10	0.3	0.1	3300	

\*Please contact us for other parts or spec.

## Physical Dimensions: (mm)

YL-T1

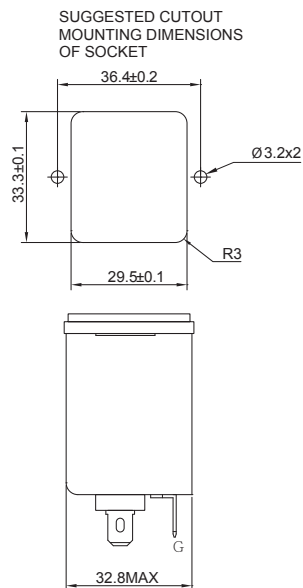
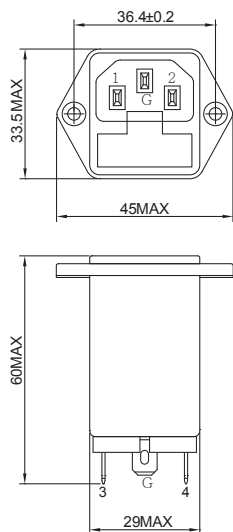

YL-T1-2F

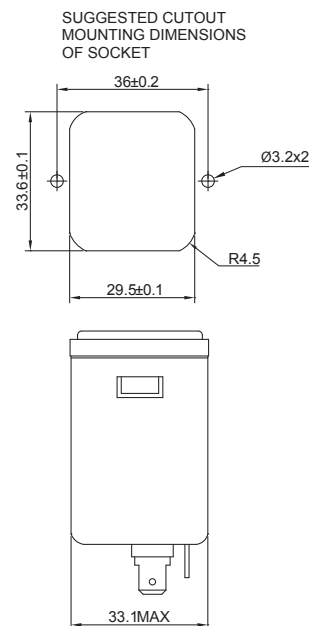
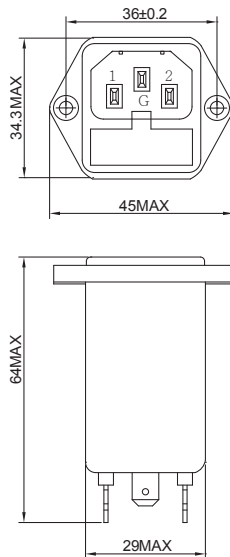

YL (Lead-wire)

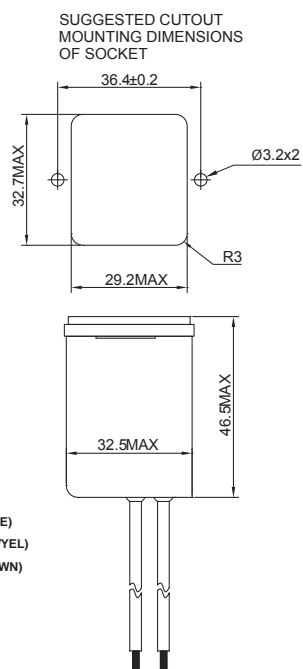
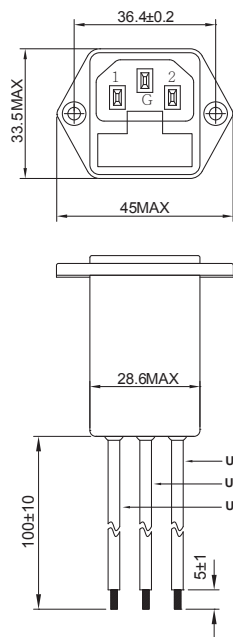

## Typical filter attenuation (Common mode — Normal mode —)

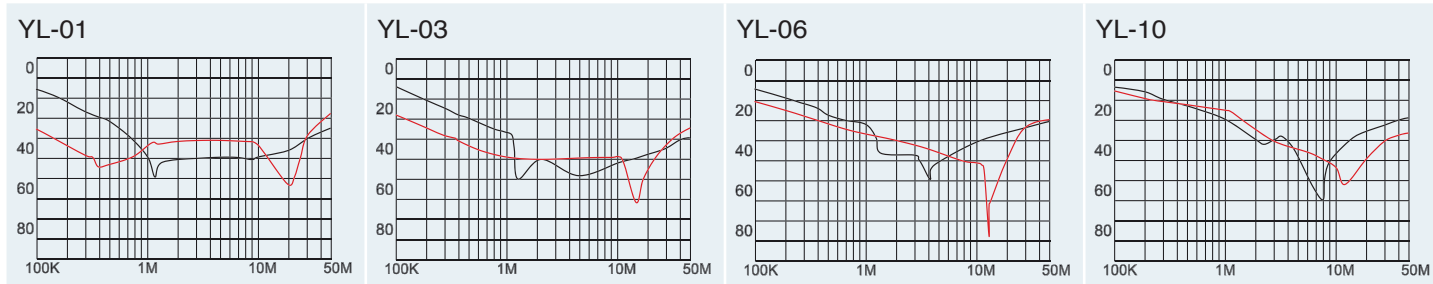

# YM, YMB SERIES (IEC Inlet Filters)



## Features

- General purpose filter providing effective EMI suppression of both line-to-line and line-to-ground noise.
- Low leakage current version upon requested.
- Approved by CE
- YM15T1 is approved by UL.
- Applications comprising Electrical and electronic equipment, UPS, Single-phase power supplies, Power Inverter.
- Custom-specific versions are available on request

## Technical Specification

Rated voltage	125/250VAC
Rated currents	up to 20A
Operating frequency	50/60Hz
Hipot rating(Line-to-line)	1450VDC
Hipot rating(Line-to-ground)	2250VDC
Operating temperature	-25~+85°C
Safety compliance	CE,YM15T1(UL)

## Typical electrical schematic

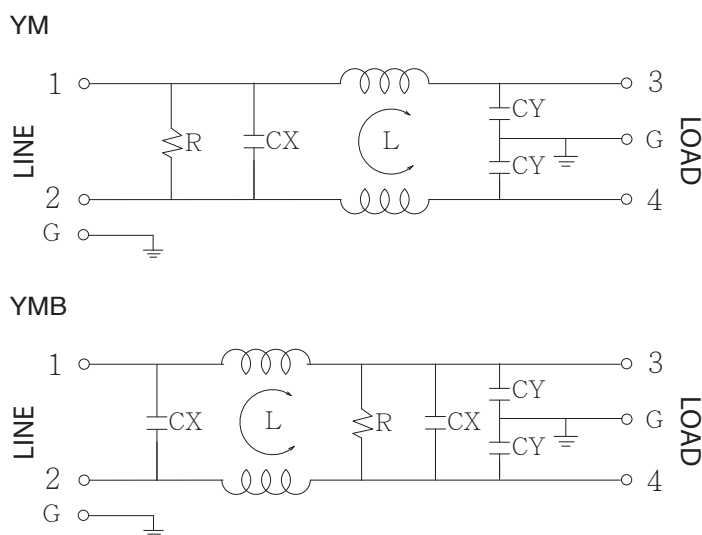

## Filter Selection Table

Part No.	Rated Current (A)	Inductance L(mH)	Capacitance CX( $\mu$ F)	Capacitance CY(pF)	Resistance R(ohm)	Output connections
YM15T1	15	3.6	2	10000	200K	Fast-on terminal
YM16T1	16	3.6	2	10000	200K	
YMB10T1	10	4.8	0.33	3300	330K	

## Physical Dimensions: (mm)

YM15T1

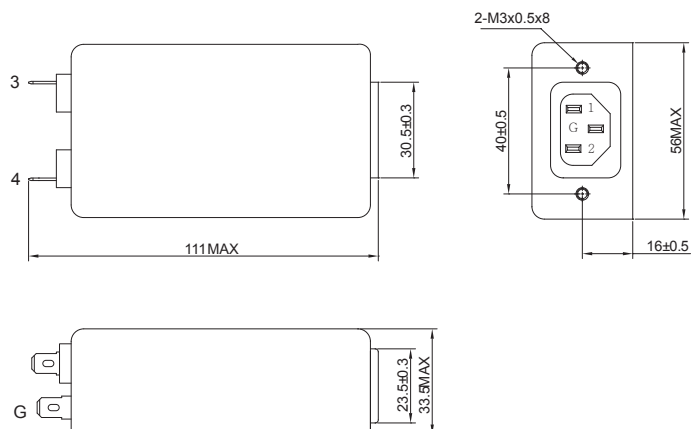

YM16T1

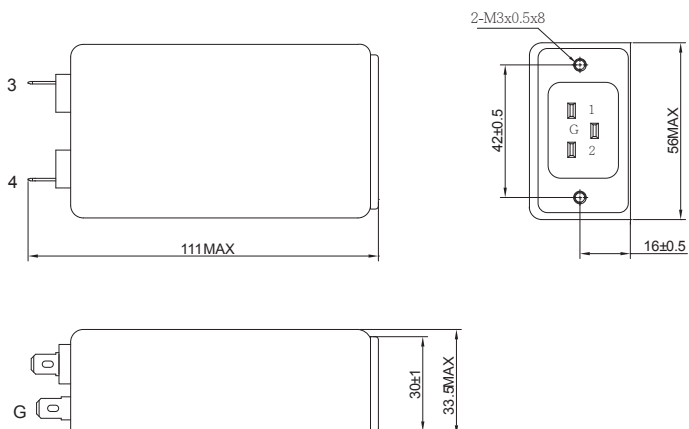

YMB

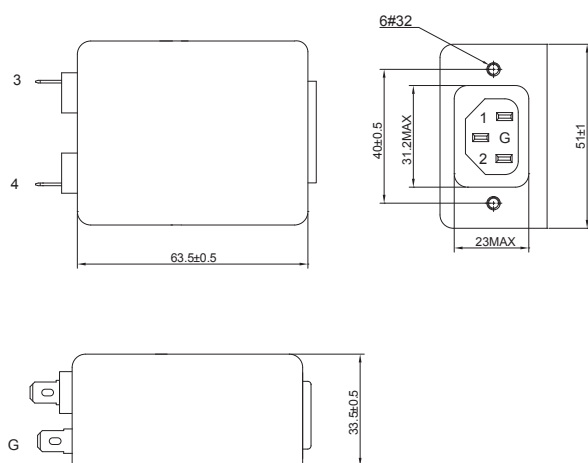

## Typical filter attenuation (Common mode — Normal mode —)

YM15T1

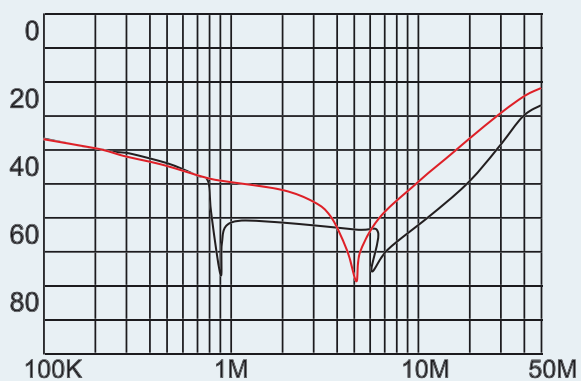

YM16T1

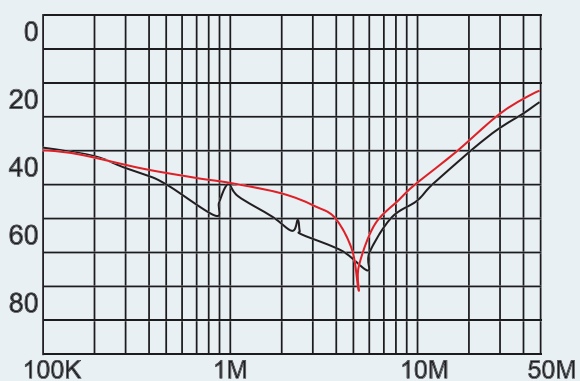

YMB

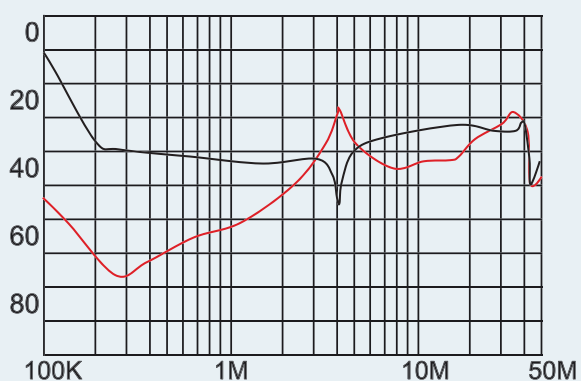



# YMA SERIES (IEC Inlet Filters)



## Features

- General purpose filters with IEC connector providing effective EMI suppression of line to line and line to ground noise.
- Offer in screw-in & snap-in two versions with fast-on terminal.
- All parts are approved by UL, CSA and CE
- Applications comprising Electrical and electronic equipment, Rack mounting equipment, Single-phase power supplies
- Custom-specific versions are available on request

## Technical Specification

Rated voltage	125/250VAC
Rated currents	up to 20A
Operating frequency	50/60Hz
Hipot rating(Line-to-line)	1450VDC
Hipot rating(Line-to-ground)	2250VDC
Operating temperature	-25~+85°C
Safety compliance	UL, CSA, CE

## Typical electrical schematic

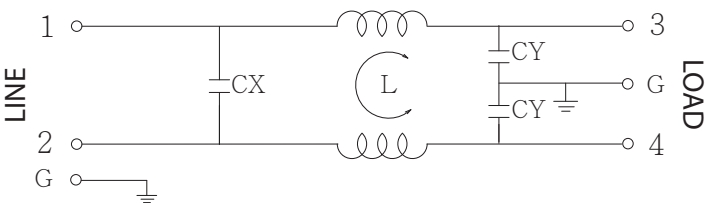

## Filter Selection Table

Part No.	Rated Current (A)	Inductance L(mH)	Capacitance CX(μF)	Capacitance CY(pF)	Output connections
YMA15A1	15	1	0.1	2200	Fast-on terminal
YMA20A1-MA	20	0.3	0.1	2200	
YMA20A1-MO	20	0.3	0.1	2200	

## Physical Dimensions: (mm)

YMA-MA

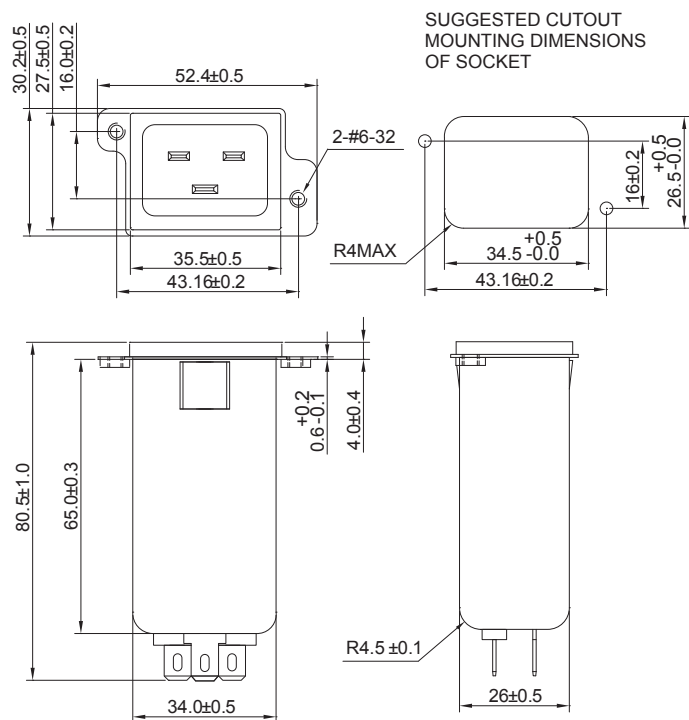

YMA-MO

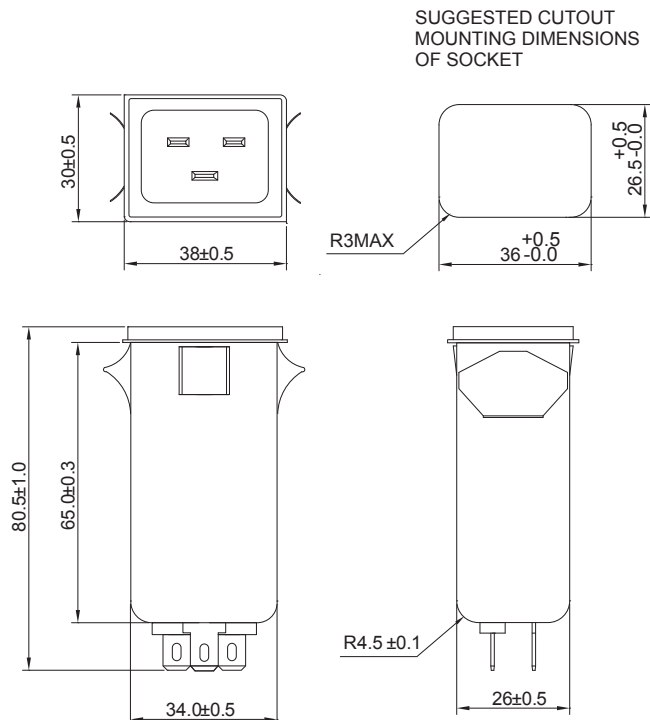

## Typical filter attenuation (Common mode — Normal mode —)

YMA15

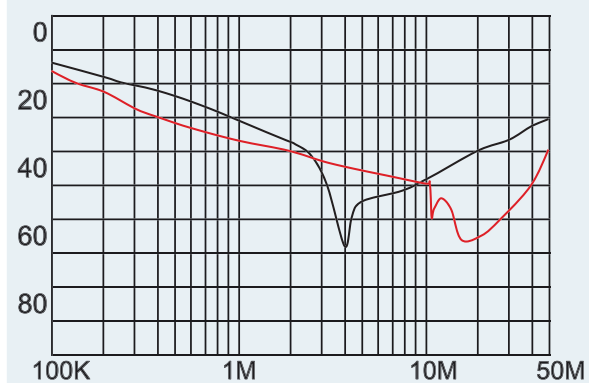

YMA20

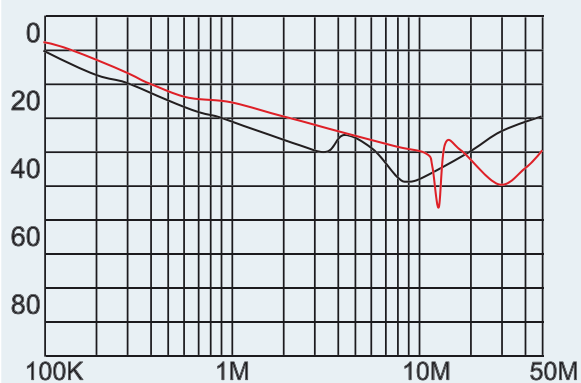

# YO SERIES (IEC Inlet Filters)



## Features

- The YO series filter integrates an IEC inlet and filter with excellent noise suppression performance and compact size.
- The rated current can be offered up to 15 amps.
- Offer in snap-in mounting type with optional vertical & horizontal version for saving labor cost.
- The choice of integrated earth line choke is also available.
- Low leakage current version upon requested.
- All parts are approved by UL, CSA, VDE, CQC and CE.
- Application for Electrical and electronic equipment, Single-phase power supplies, UPS, Medical equipment, Test and measurement equipment.
- Custom-specific versions are available on request.

## Technical Specification

Rated voltage	125/250VAC
Rated currents	1 to 15A
Operating frequency	50/60Hz
Hipot rating(Line-to-line)	1450VDC
Hipot rating(Line-to-ground)	2250VDC
Operating temperature	-25~+85°C
Safety compliance	1 to 10A(VDE, CQC) ; 1 to 15A(UL, CSA, CE)

\*VDE except 8A

## Typical electrical schematic

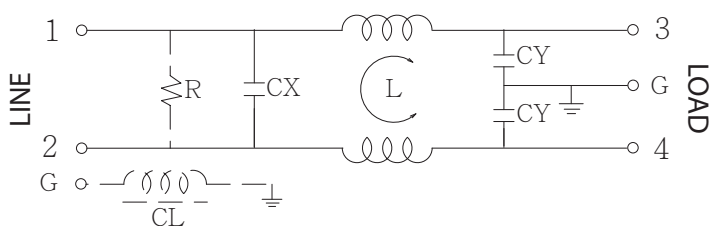

\* With optional ground choke and resistor.

R: 1M ohm

CL: 100  $\mu$  H

## Filter Selection Table

Part No.	Rated Current (A)	Inductance L(mH)	Capacitance CX( $\mu$ F)	Capacitance CY(pF)	Output connections
YO01T1	1	3.7	0.1	3300	Fast-on terminal (optional lead-wire)
YO03T1	3	1.8	0.1	3300	
YO06T1	6	0.7	0.1	3300	
YO08T1	8	1.8	0.1	3300	
YO10T1	10	0.3	0.1	3300	
YO15T1	15	0.3	0.1	3300	
YO01T3	1	3.7	0.1	3300	Solder lug terminal
YO03T3	3	1.8	0.1	3300	
YO06T3	6	0.7	0.1	3300	
YO08T3	8	1.8	0.1	3300	
YO10T3	10	0.3	0.1	3300	
YO15T3	15	0.3	0.1	3300	

\*Please contact us for other parts or spec.

## Physical Dimensions: (mm)

YO-T1-BU

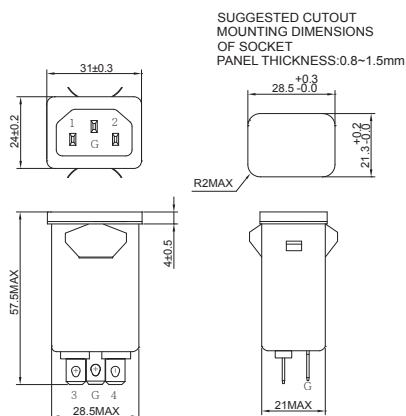

YO-T1-BR

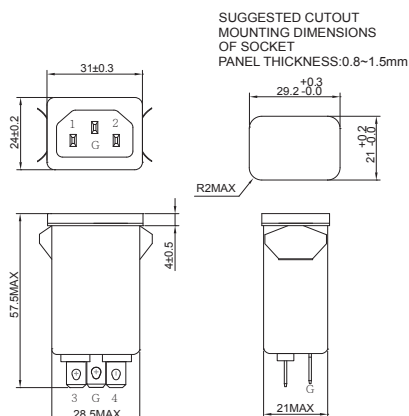

YO-D (Lead wire)

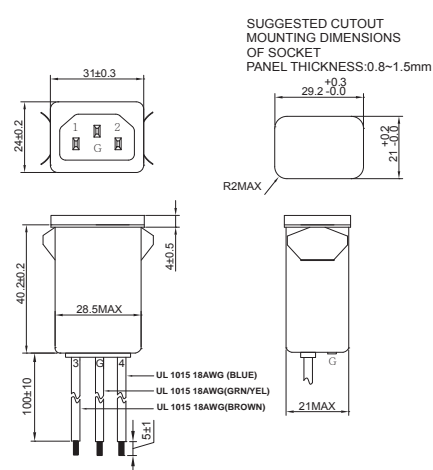

YO-T3-BU

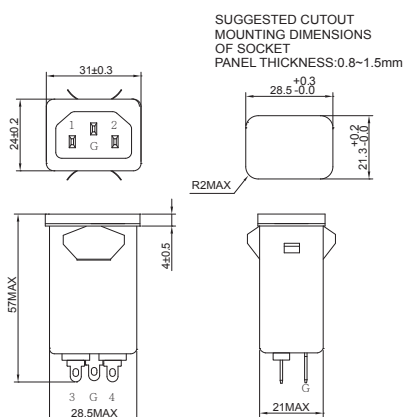

YO-T3-BR

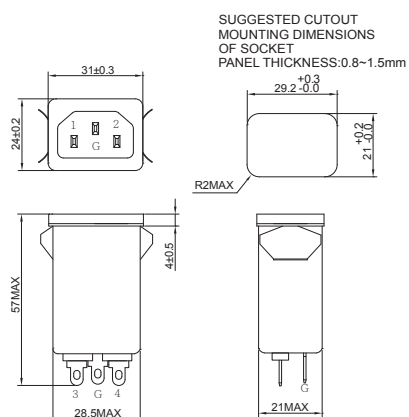

## Typical filter attenuation (Common mode — Normal mode —)

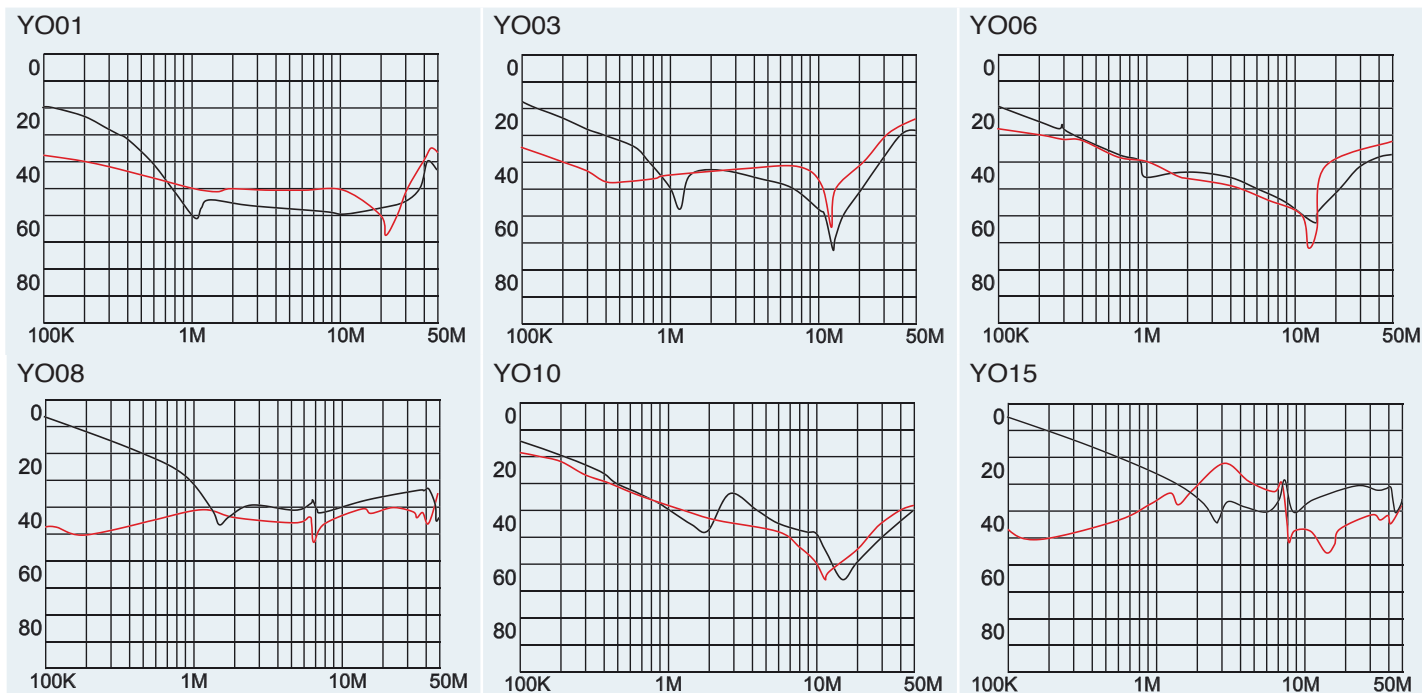

# YP SERIES (3-Phase 3-Wire Filters,3-Phase 4-Wire Filters)



## Features

- Good noise attenuation in both forward and reverse directions for common mode and normal mode.
- High reliability designed for industrial equipment usage with 3-Phase 3-Wire and 3-Phase 4-Wire.
- The rated current can be offered from 60 to 250 amps.
- Various screw terminals output for different amps is designed for easy installation.
- Custom-specific versions are available on request.

## Technical Specification

Rated voltage	500VAC
Rated currents	up to 250A
Operating frequency	50/60Hz
Hipot rating(Line-to-line)	1450VDC
Hipot rating(Line-to-ground)	2250VDC
Operating temperature	-25~+85°C
Safety compliance	CE

## Typical electrical schematic

YP-T8, YP-T10

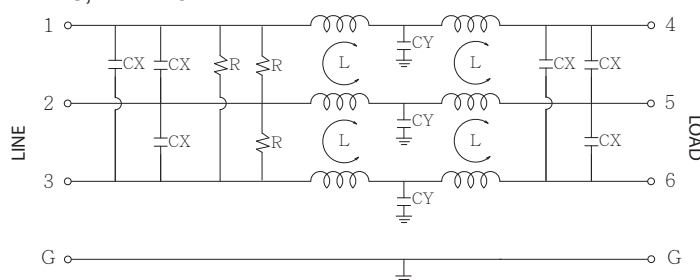

YP-T12

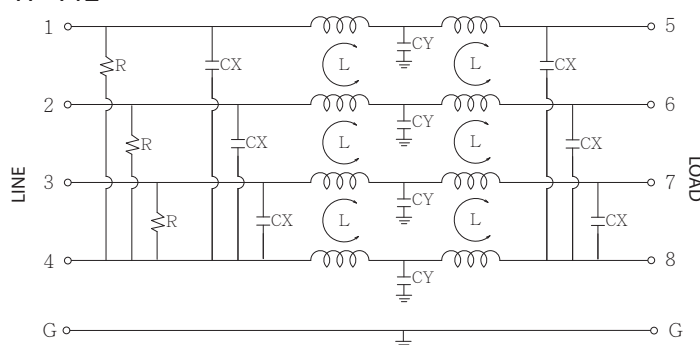

## Filter Selection Table

Part No.	Rated Current (A)	Inductance L(μH)	Capacitance CX(μF)	Capacitance CY(pF)	Resistance R(ohm)	Output connections
YP60T8	60	800	2.2	30000	200K	M8 Screw terminals
YP80T10	80	350	2.2	30000	10M	M10 Screw terminals
YP100T10	100	90	2.2	30000	200K	M12 Screw terminals
YP150T12	150	90	3.3	30000	200K	
YP200T12	200	100	3.3	40000	200K	
YP250T12	250	100	3.3	40000	200K	

## Physical Dimensions: (mm)

YP-T8

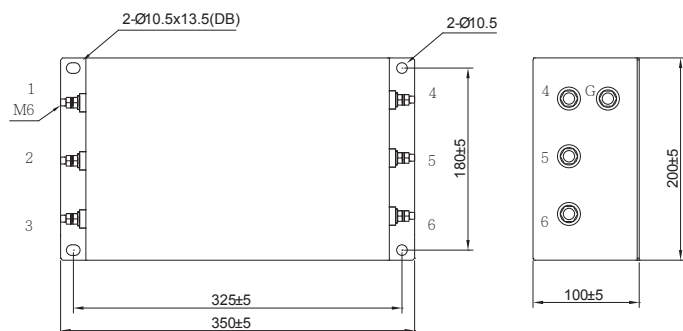

YP-T10

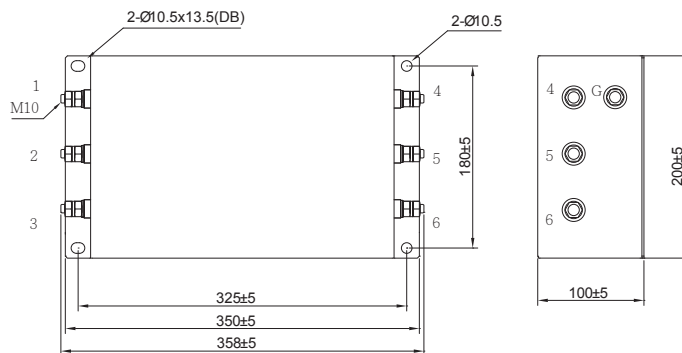

YP-T12

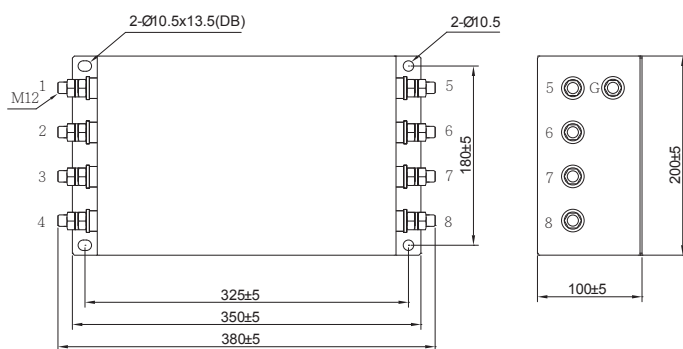

## Typical filter attenuation (Common mode — Normal mode —)

YP60

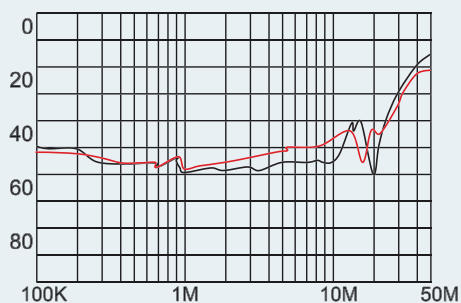

YP80

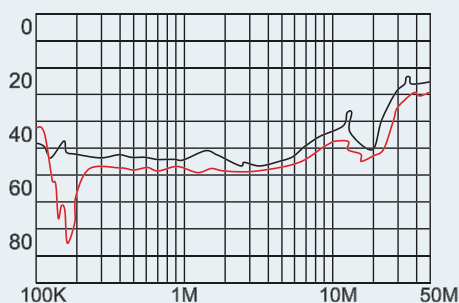

YP100

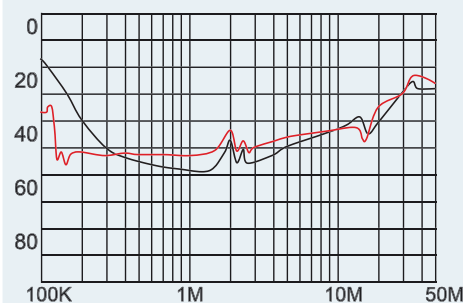

YP150

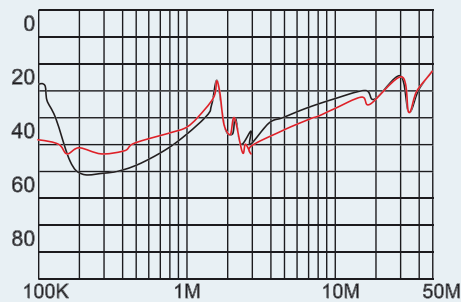

YP200

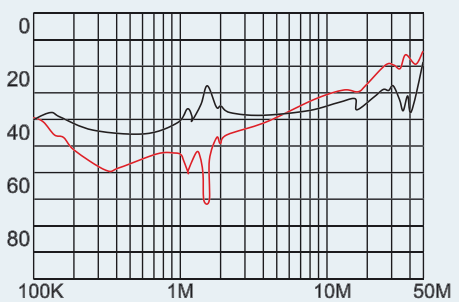

YP250

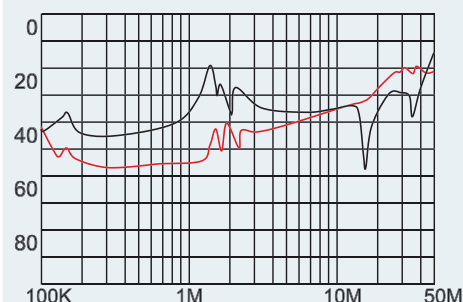

# YQ SERIES (Power Entry Module Filters)



## Features

- Power entry model filters with an IEC inlet , a mains filter with dual- fuse holder and a 2-pole rocker switch.
- The rated current can be offered up to 10 amps.
- Fuses Ø 5 x 20 mm
- All parts are approved by VDE except YQ10A1
- Applications comprising Game-Player Machine, Test and measurement equipment , Medical equipment
- Custom-specific versions are available on request.

## Technical Specification

Rated voltage	125/250VAC
Rated currents	1 to 10A
Operating frequency	50/60Hz
Hipot rating(Line-to-line)	1450VDC
Hipot rating(Line-to-ground)	2250VDC
Operating temperature	-25~+85°C
Safety compliance	CE,1 to 6A (VDE)

## Typical electrical schematic

1~6A type

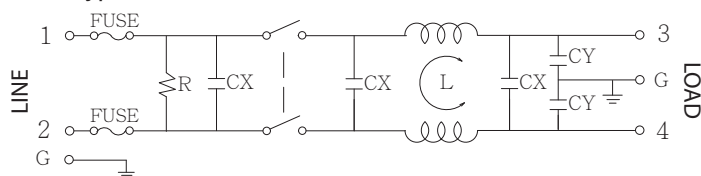

10A type

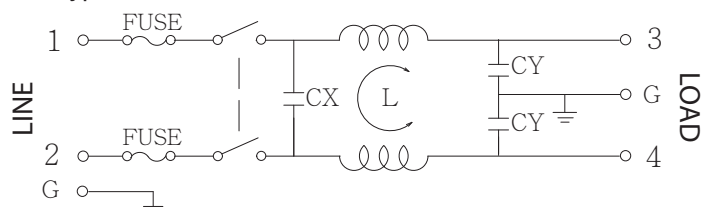

## Filter Selection Table

Part No.	Rated Current (A)	Inductance L(mH)	Capacitance CX(μF)	Capacitance CY(pF)	Resistance R(ohm)	Output connections
YQ01A1	1	10.5	0.22	2200	1M	Fast-on terminal
YQ02A1	2	4.6	0.22	2200	1M	
YQ04A1	4	2.5	0.22	2200	1M	
YQ06A1	6	0.8	0.22	2200	1M	
YQ10A1	10	0.3	0.1	3300	-	

## Physical Dimensions: (mm)

YQ

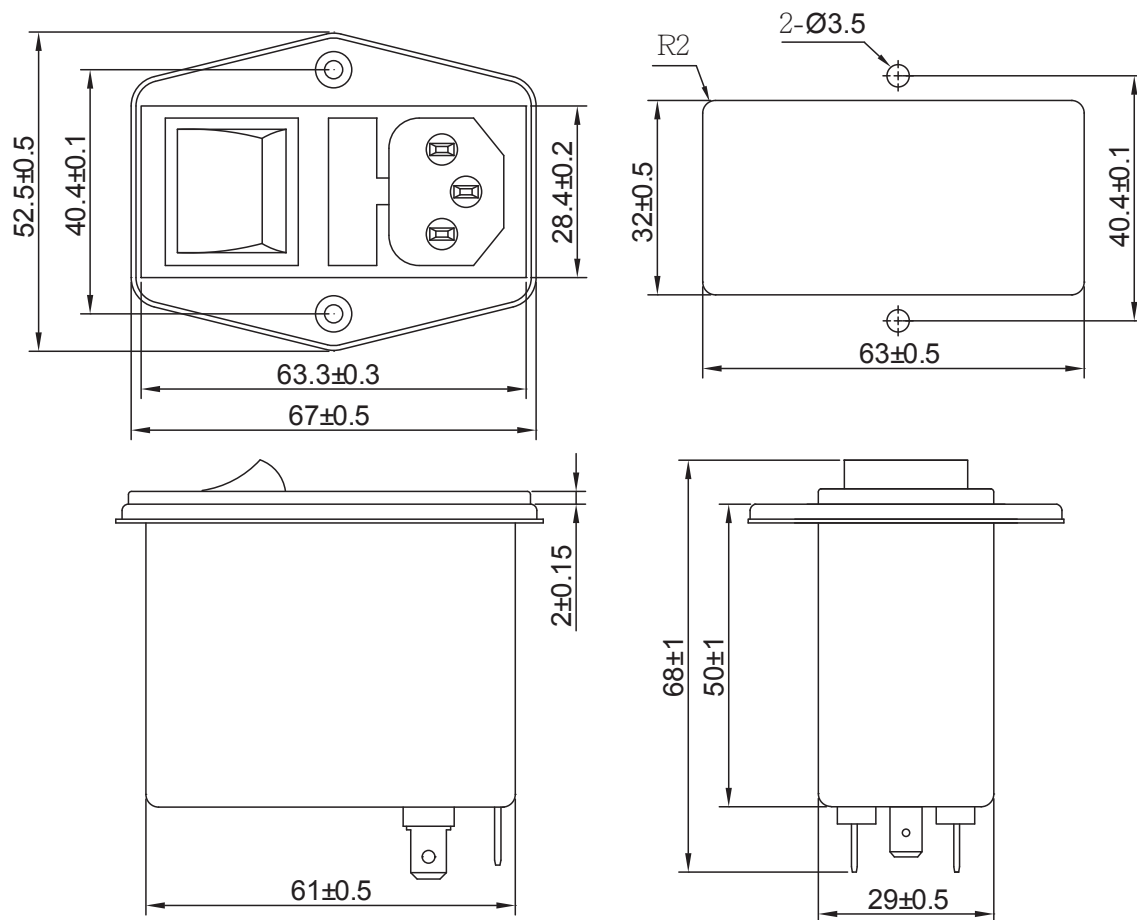

## Typical filter attenuation (Common mode — Normal mode —)

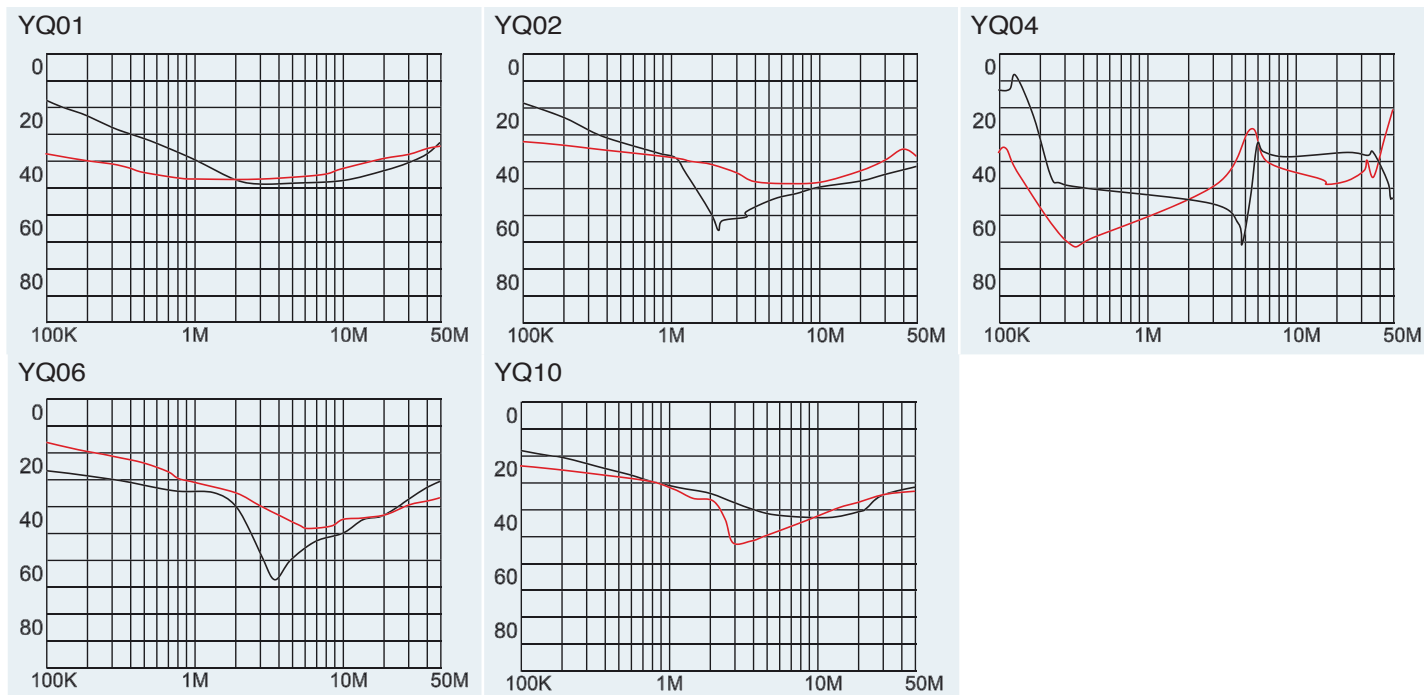



# YR SERIES (Power Entry Module Filters)



## Features

- The YR series filter integrates an IEC inlet, filter and switch with excellent noise suppression performance and compact size.
- It is designed in snap-in mounting for easy installation.
- The rated current can be offered up to 10 amps.
- All parts are approved by UL ,CUL, VDE, CQC and CE
- Applications comprising Electrical and electronic equipment, Single-phase power supplies ,Test and measurement equipment, Medical equipment
- Custom-specific versions are available on request

## Technical Specification

Rated voltage	125/250VAC
Rated currents	1 to 10A
Operating frequency	50/60Hz
Hipot rating(Line-to-line)	1450VDC
Hipot rating(Line-to-ground)	2250VDC
Operating temperature	-25~+85°C
Safety compliance	UL, CUL, VDE, CQC, CE

## Typical electrical schematic

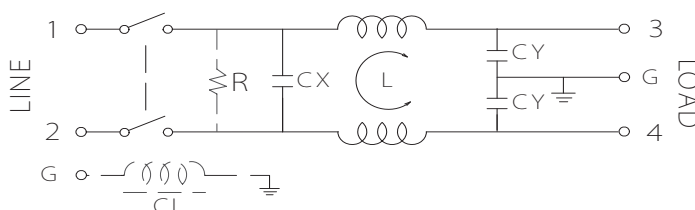

\*With optional ground choke and resister.  
R: 1M ohm  
CL: 100  $\mu$  H

## Filter Selection Table

Part No.	Rated Current (A)	Inductance L(mH)	Capacitance CX( $\mu$ F)	Capacitance CY(pF)	Output connections
YR01A1	1	3.7	0.1	3300	Fast-on terminal
YR03A1	3	1.8	0.1	3300	
YR06A1	6	0.7	0.1	3300	
YR10A1	10	0.3	0.1	3300	
YR01A3	1	3.7	0.1	3300	Solder lug terminal
YR03A3	3	1.8	0.1	3300	
YR06A3	6	0.7	0.1	3300	
YR10A3	10	0.3	0.1	3300	

\*Please contact us for other parts or spec.

## Physical Dimensions: (mm)

YR-A1

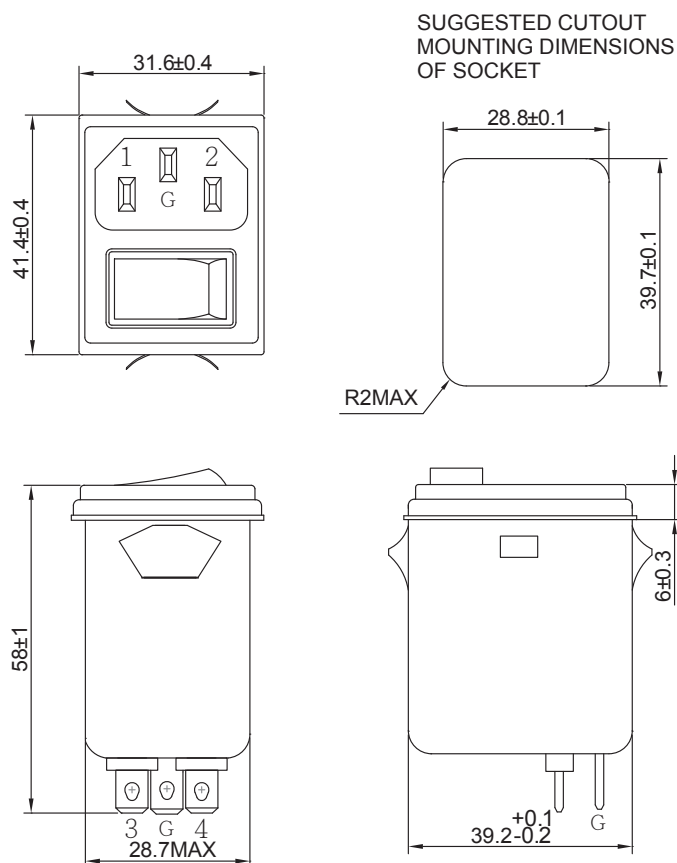

YR-A3

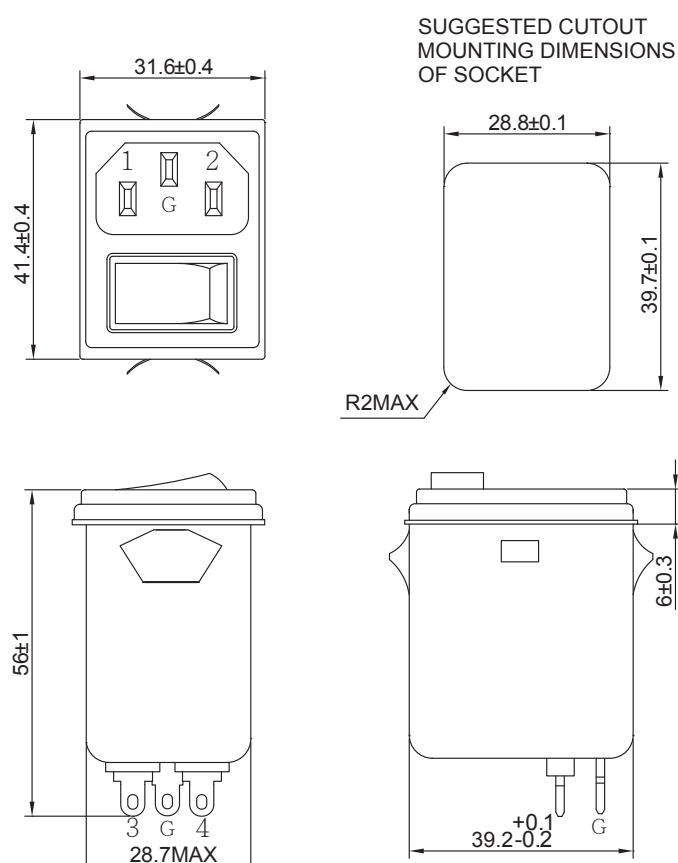

## Typical filter attenuation (Common mode — Normal mode —)

YR01

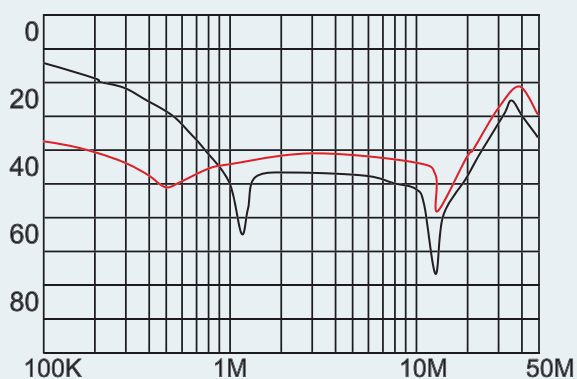

YR03

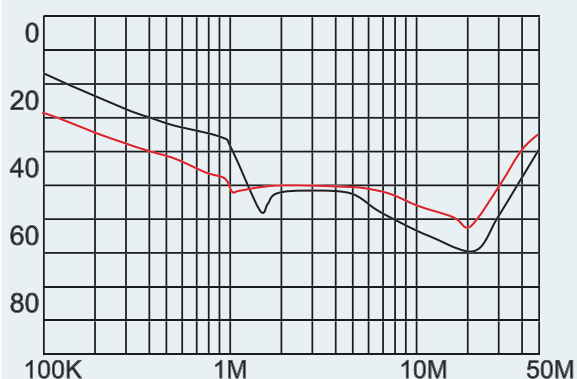

YR06

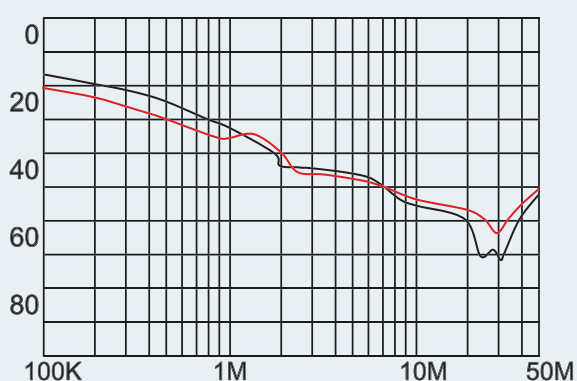

YR10

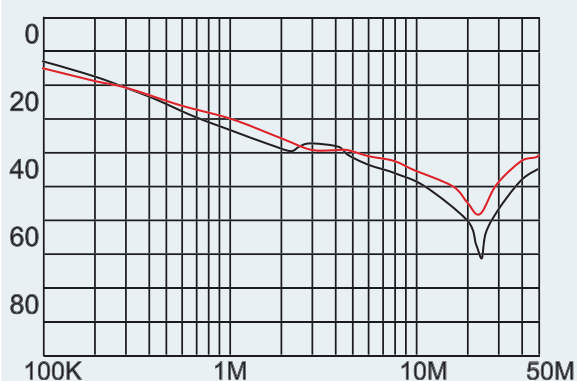

# YT SERIES (Household Applications Filters)



## Features

- The YT series filter has excellent noise suppression performance.
- Compact easy to mount cylindrical filter
- The rated current can be offered up to 16 amps.
- Approved by CE
- Applications comprising in Household equipment, office equipment and household appliances (washing machines and dryers)
- Custom-specific versions are available on request.

## Technical Specification

Rated voltage	125/250VAC
Rated currents	Up to 16A
Operating frequency	50/60Hz
Hipot rating(Line-to-line)	1450VDC
Hipot rating(Line-to-ground)	2250VDC
Operating temperature	-25~+85°C
Safety compliance	CE

## Typical electrical schematic

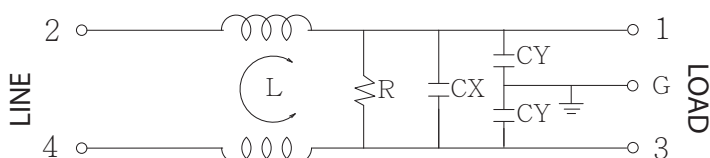

## Filter Selection Table

Part No.	Rated Current (A)	Inductance L(mH)	Capacitance CX(μF)	Capacitance CY(pF)	Resistance R(ohm)	Output connections
YT10TA-H	10	2	1	10000	680K	Fast-on terminal
YT16TA-H	16	1	0.47	10000	680K	
YT10TA-M8	10	1	0.47	2200	1M	
YT16TA-M8	16	1	0.47	10000	1M	
YT10A1	10	0.5	0.47	25000	680K	RAST 5.0

## Physical Dimensions: (mm)

YT-TA-H

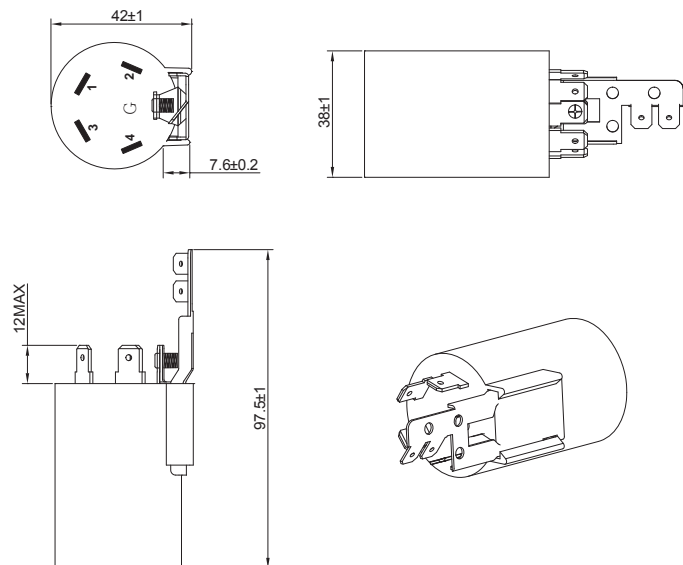

YT-TA-M8

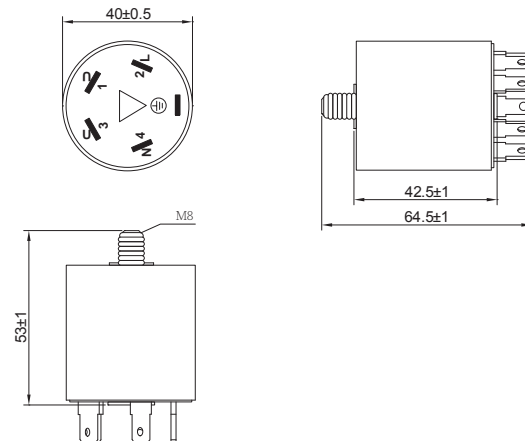

YT10A1

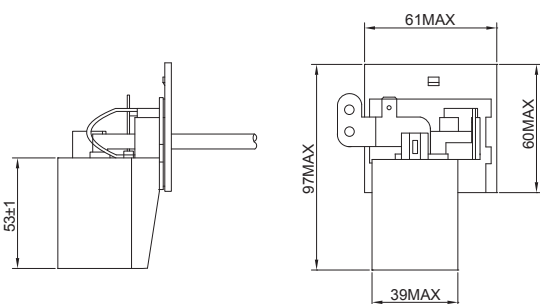

\* Customized sockets can be made on request

## Typical filter attenuation (Common mode — Normal mode —)

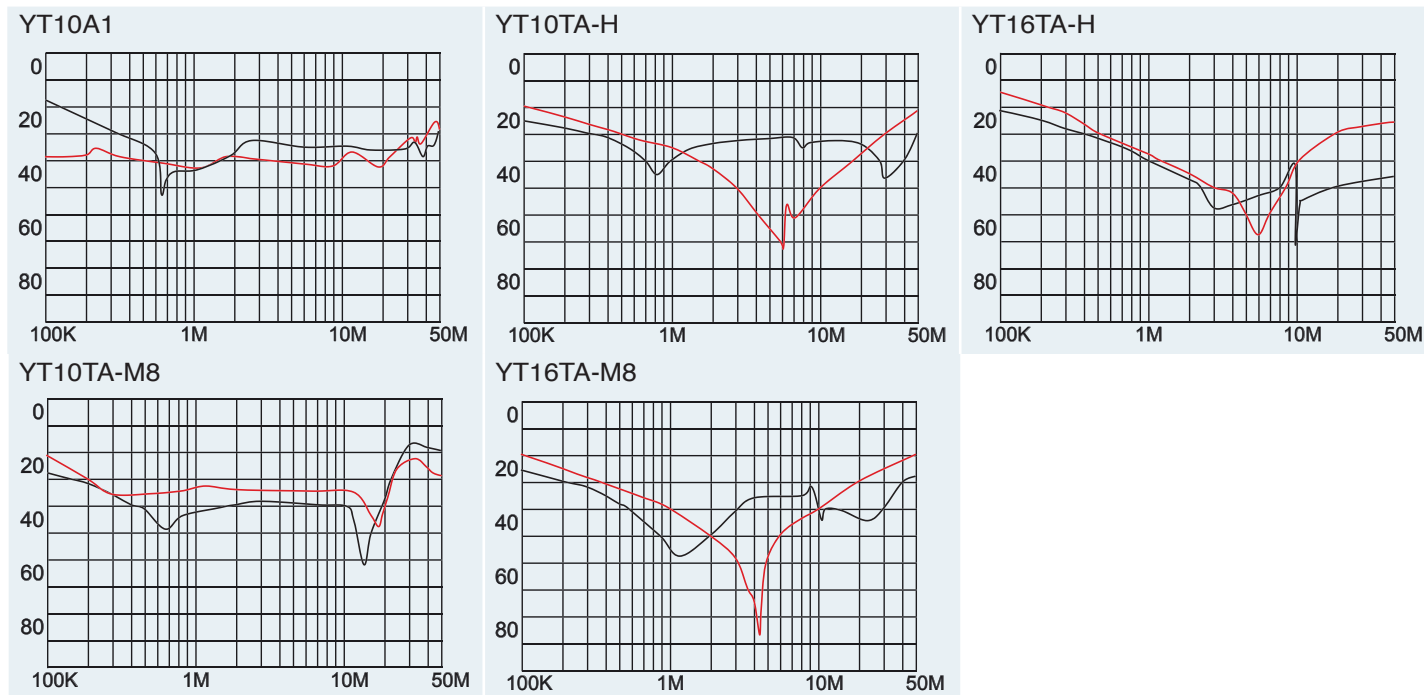

# YU-TB SERIES (3-Phase 3-Wire Filters)



## Features

- Good noise attenuation in both forward and reverse directions for common mode and normal mode
- 3-phase 3-wire filters 7 to 100A current rating
- Compact dimensions, Vertical agency, easy connection terminal block
- Typical applications in Electrical and electronic equipment, automation equipment, inverters and converters, UPS-Systems, Frequency Converters, servo drives, Power supplies, Stepper Motor Drives

## Technical Specification

Rated voltage	480 VAC
Rated currents	7 to 100A
Operating frequency	50/60Hz
Operating temperature	-25 to +85°C

## Typical electrical schematic

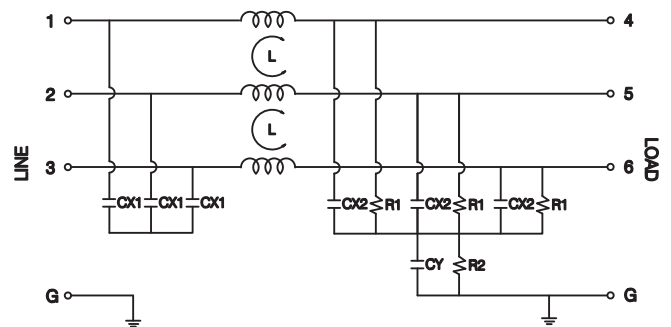

## Filter Selection Table

Part No.	Rated Current (A)	Rated voltage (VAC)	Input/output connections
YU07TB10	7	480	TB10
YU16TB20	16	480	TB20
YU30TB30	30	480	TB30
YU42TB60	42	480	TB60
YU55TB60	55	480	TB60
YU75TB80	75	480	TB80
YU100TB100	100	480	TB100

## Physical Dimensions: (mm)

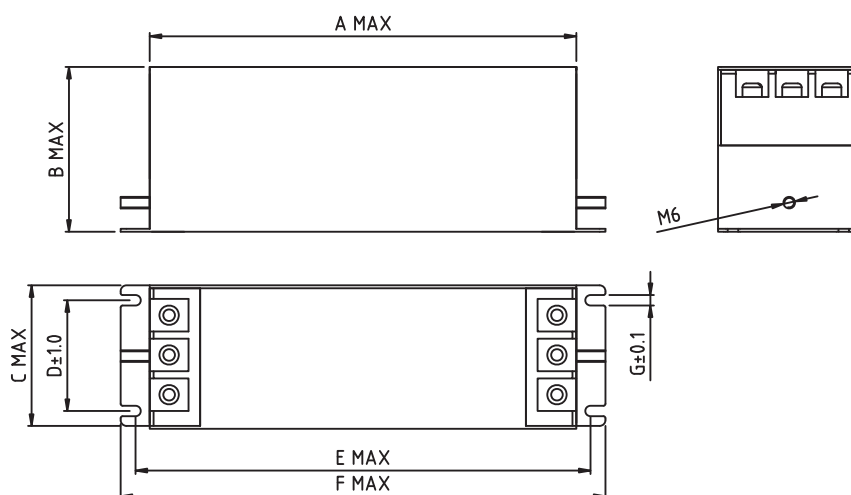

Dimension	A	B	C	D	E	F	G	Terminal
YU07TB10	160	70	38.5	21.6	174.6	190	5.4	TB10
YU16TB20	220	70	44	28.6	234.6	250	5.4	TB20
YU30TB30	240	85	50.5	33.6	254.6	270	5.4	TB30
YU42TB60	220	85	74	57.1	234.6	250	5.4	TB60
YU55TB60	240	85	74	57.1	254.6	270	5.4	TB60
YU75TB80	240	135	74	57.1	254.6	270	5.4	TB80
YU100TB100	240	135	93	76.1	254.6	270	5.4	TB100

## Typical filter attenuation (Common mode — Normal mode —)

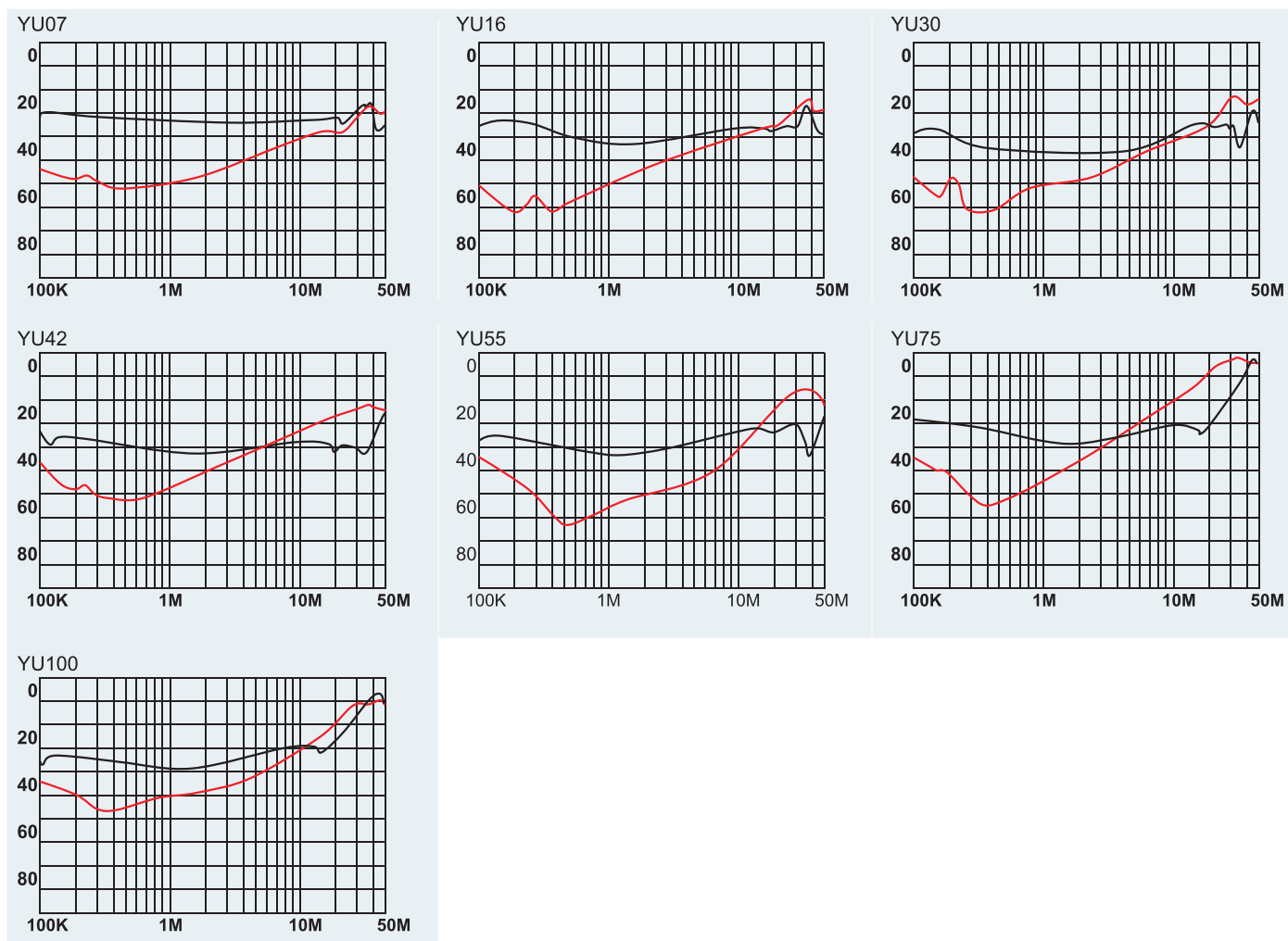

# YU-HD SERIES (3-Phase 3-Wire Filters)



## Features

- Good noise attenuation in both forward and reverse directions for common mode and normal mode
- 3-phase 3-wire filters 7 to 100A current rating
- Compact dimensions, Vertical agency, easy connection terminal block
- Typical applications in Electrical and electronic equipment, automation equipment, inverters and converters, UPS-Systems, Frequency Converters, servo drives, Power supplies, Stepper Motor Drives

## Technical Specification

Rated voltage	480 VAC
Rated currents	7 to 100A
Operating frequency	50/60Hz
Operating temperature	-25 to +85°C

## Typical electrical schematic

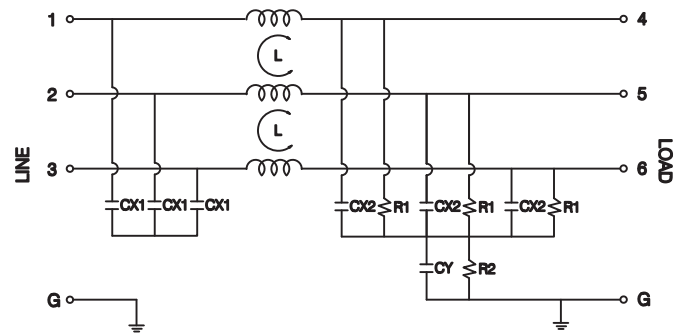

## Filter Selection Table

Part No.	Rated Current (A)	Rated voltage (VAC)	Input/output connections
YU07HD10	7	480	HD10
YU16HD10	16	480	HD10
YU30HD10	30	480	HD10
YU42HD50	42	480	HD50
YU55HD50	55	480	HD50
YU75HD50	75	480	HD50
YU100HD95	100	480	HD95

## Physical Dimensions: (mm)

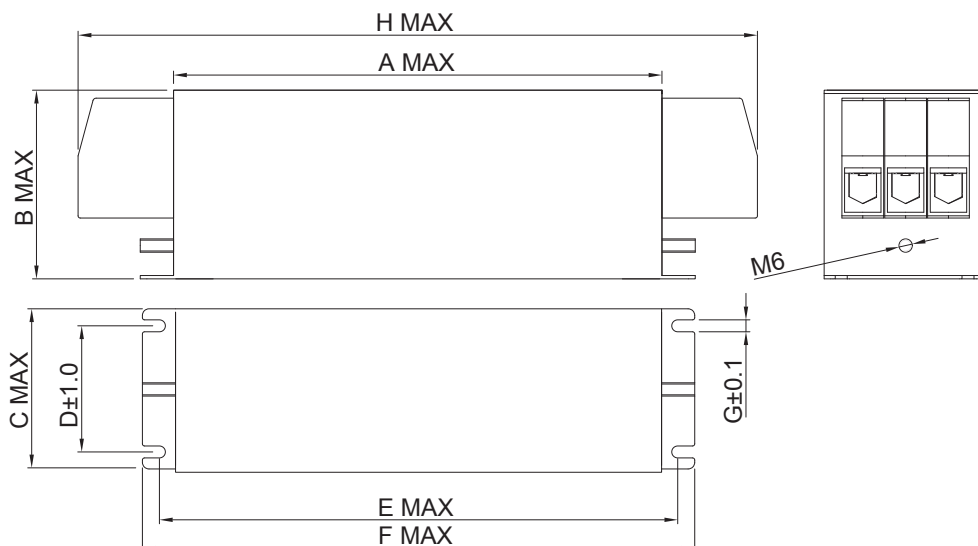

Dimension	A	B	C	D	E	F	G	H	Terminal
YU07HD10	160	70	38	21.6	174.6	190	5.4	209	HD10
YU16HD10	220	70	46	28.6	234.6	250	5.4	269	HD10
YU30HD10	240	85	50.5	33.6	254.6	270	5.4	289	HD10
YU42HD50	220	85	74	57.1	234.6	250	5.4	306	HD50
YU55HD50	240	85	74	57.1	254.6	270	5.4	326	HD50
YU75HD50	240	135	74	57.1	254.6	270	5.4	326	HD50
YU100HD95	240	135	93	76.1	254.6	270	5.4	341	HD95

## Typical filter attenuation (Common mode — Normal mode —)

